

Recommended P.C.B. Layout  
Thickness=1.6mm

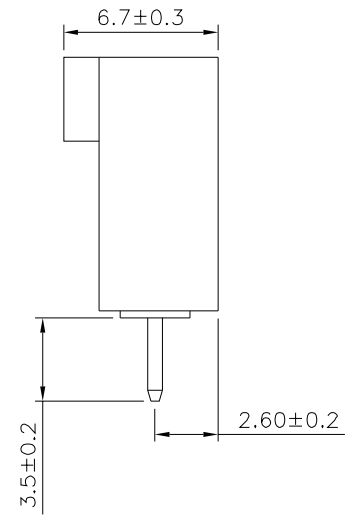
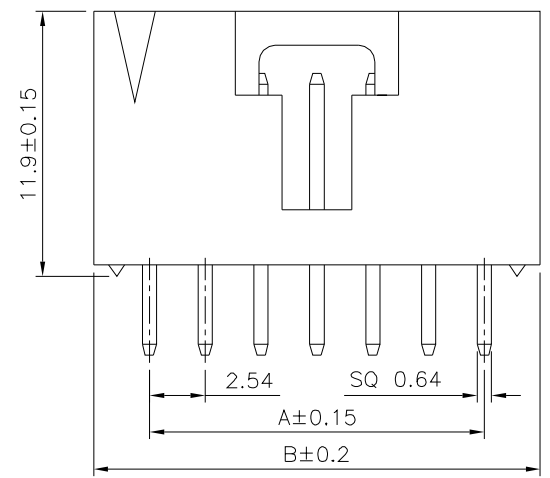
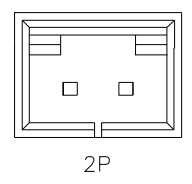
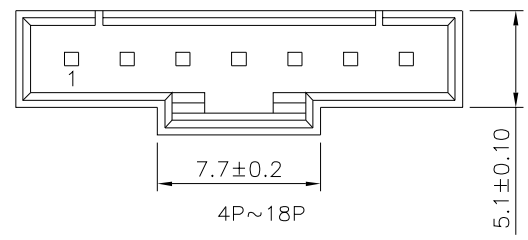
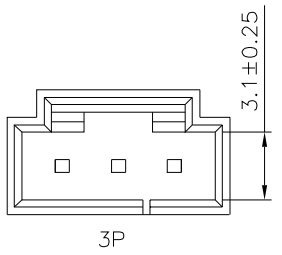

**SPECIFICATION**  
 Current Rating:2.5A AC/DC  
 Voltage Rating:250V AC/DC  
 Insulation Resistance:1000 Megaohms Min.  
 Withstand Voltage:600V AC/Minute  
 Temperature Range:-25°C~+85°C  
 Insulator:PBT(UL94V-0),Black  
 Contact:Brass,Gold Flash Over All,Over Nickel  
 RoHS Compliant

Pin	A	B	Pin	A	B
02	2.54	7.62	11	25.40	30.48
03	5.08	10.16	12	27.94	33.02
04	7.62	12.70	13	30.48	35.56
05	10.16	15.24	14	33.02	38.10
06	12.70	17.78	15	35.56	40.64
07	15.24	20.32	16	38.10	43.18
08	17.78	22.86	17	40.64	45.72
09	20.32	25.40	18	43.18	48.26
10	22.86	27.94			

**4UCON** 元化興業股份有限公司  
4UCON TECHNOLOGY INC.

DRAWING No.		APPROVED BY		UNLESS OTHERWISE SPECIFIED TOLERANCES ARE X. ±0.5 .X ±0.25 .XX ±0.2 .XXX ±0.08
02015		MEI		
		CHECKED BY	HZF	
		DRAWING BY	CYP	
SCALE	NONE	REV.	CO	UNIT mm

△ CO	NEW RELEASE	HZF	10/25/2017
NO. REV.	REVISIONS	CHK	DATE