

SPECIFICATION
 ⚠ Current Rating:1A
 Voltage Rating:250V AC/DC
 Withstanding Voltage:500V AC/Minute
 Contact Resistance:20 Milliohms Max.
 Insulation Resistance:1000 Megaohms Min.
 Temperature Range:-40°C~+105°C
 Insulator:PBT+G.F.(UL94V-0),Black
 ⚠ Contact:Brass,Selective Gold Plated Over Nickel
 RoHS Compliant

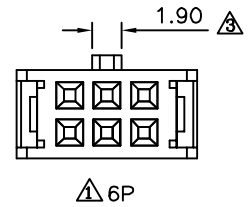
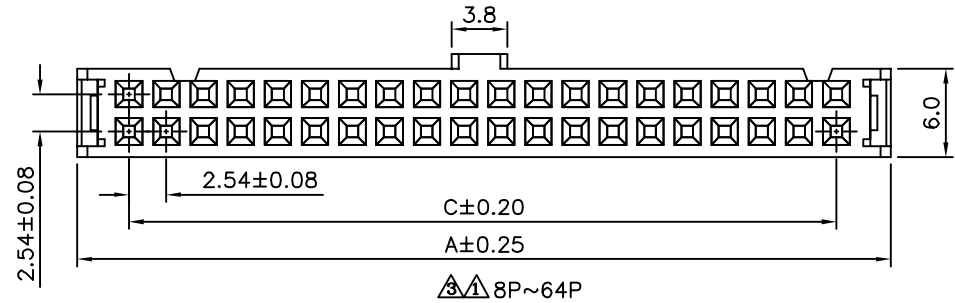
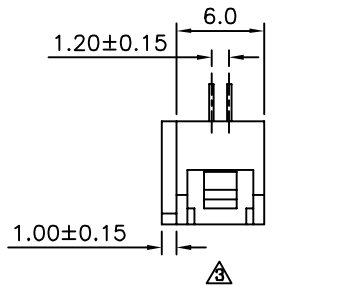
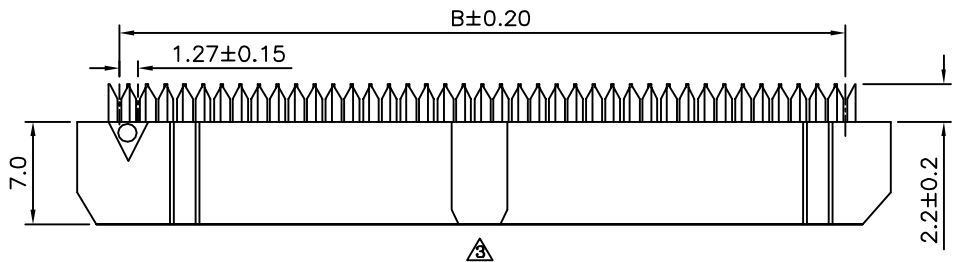
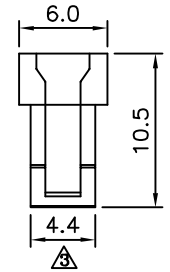
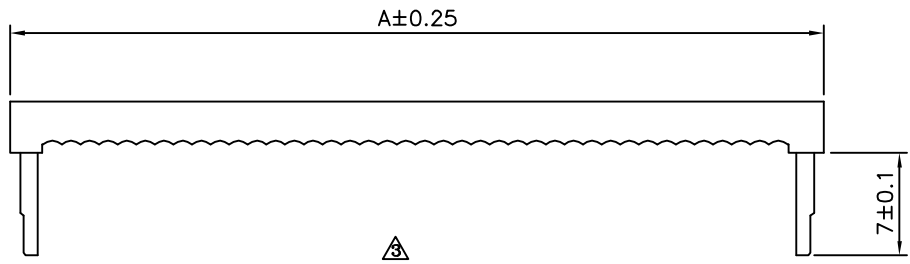

Pin	A	B	C
6	12.32	6.35	5.08
8	14.86	8.89	7.62
10	17.40	11.43	10.16
12	19.94	13.97	12.70
14	22.48	16.51	15.24
16	25.02	19.05	17.78
18	27.56	21.59	20.32
20	30.10	24.13	22.86
24	35.18	29.21	27.94
26	37.72	31.75	30.48
30	42.80	36.83	35.56
34	47.88	41.91	40.64
36	50.42	44.45	43.18
40	55.50	49.53	48.26
44	60.58	54.61	53.34
50	68.20	62.23	60.96
60	80.90	74.93	73.66
64	85.98	80.01	78.74

4UCON 元化興業股份有限公司
 4UCON TECHNOLOGY INC.

DRAWING No.		APPROVED BY		UNLESS OTHERWISE SPECIFIED TOLERANCES ARE ⚠ X: ±0.3 .X ±0.2 .XX ±0.1 .XXX ±0.05
02023		EMILY		
		CHECKED BY		
		HZF		
		DRAWING BY		UNIT mm
		SONG		
SCALE	NONE	REV.	A3	NO.REV.

⚠ A3	Modify Data	HZF	05/24/2012
⚠ A2	Modify Data	HZF	10/06/2010
⚠ A1	Modify Data	HZF	08/13/2010
⚠ A0	NEW RELEASE	HZF	10/20/2009
NO.REV.	REVISIONS	CHK	DATE