

SPECIFICATION

Current Rating:3 Amp
 Voltage Rating:250V AC/RMS 60Hz
 Contact Resistance:20 Milliohms Max. At 1 Amp DC
 Insulation Resistance:1000 Megaohms At 500V DC
 Dielectric Withstanding Voltage:1000V AC/RMS 60Hz
 For 1 Minute
 Insulator:PBT+G.F.(UL94V-0),Blue
 Contact:Brass,Selective Gold Flash Over Nickel
 Shell:Steel,Tin Plated Over Copper
 RoHS Compliant

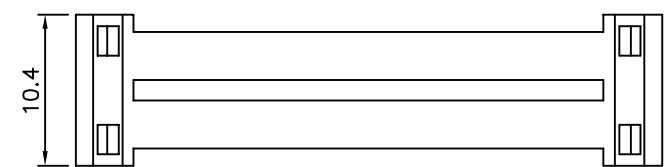
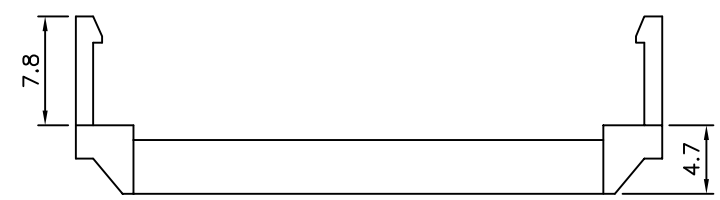
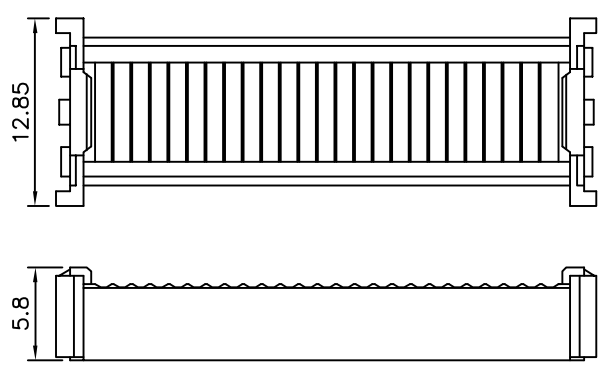
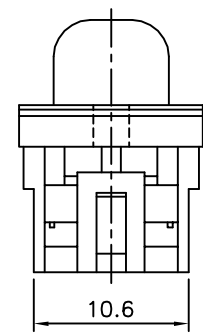
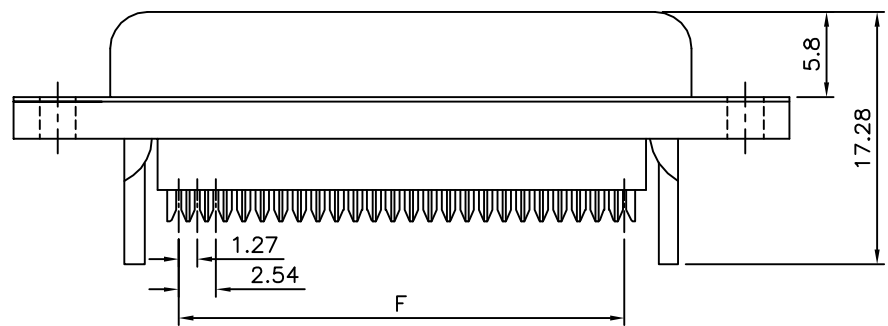

| Pin | A | B | C | E | F |
|-----|-------|-------|-------|-------|-------|
| 09 | 30.81 | 24.99 | 16.33 | 11.08 | 10.16 |
| 15 | 39.20 | 33.30 | 24.66 | 19.39 | 17.78 |
| 25 | 53.05 | 47.04 | 38.38 | 33.24 | 30.48 |
| 37 | 69.40 | 63.50 | 54.84 | 49.86 | 45.72 |

4UCON 元化興業股份有限公司
 4UCON TECHNOLOGY INC.

| | | | | |
|-------------|------|-------------|----|---|
| DRAWING No. | | APPROVED BY | | UNLESS OTHERWISE SPECIFIED TOLERANCES ARE X. ±0.38 X.* ±3.0° .X ±0.25 .X.* ±1.0° .XX ±0.13 |
| 03034 | | EMILY | | |
| | | CHECKED BY | | |
| | | HZF | | |
| | | DRAWING BY | | UNIT mm |
| | | SONG | | |
| SCALE | NONE | REV. | A1 | |

| | | | | |
|-----|------|-------------|-----|------------|
| NO. | REV. | REVISIONS | CHK | DATE |
| △A1 | | Modify Data | HZF | 10/04/2013 |
| △A0 | | NEW RELEASE | HZF | 06/03/2008 |