

Recommended P.C.B. Layout

SPECIFICATION

Current Rating: 3 Amperes
 Voltage Rating: 800V AC 1 Minute
 Contact Resistance: 20 Milliohms Max.
 Insulation Resistance: 5000 Megaohms Min.
 Operating Temperature: -55°C ~ +105°C
 Insertion Force: 412 Grams Max. Per Pair
 Withdrawal Force: 32 Grams Min. Per Pair
 Insulator: PBT+G.F.(UL94V-0), Black
 Contact: Phosphor Bronze, Gold Flash On Contact Area, Tin Plated On Solder Tails, Over Nickel
 RoHS Compliant

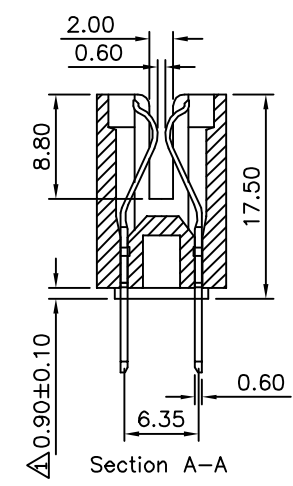
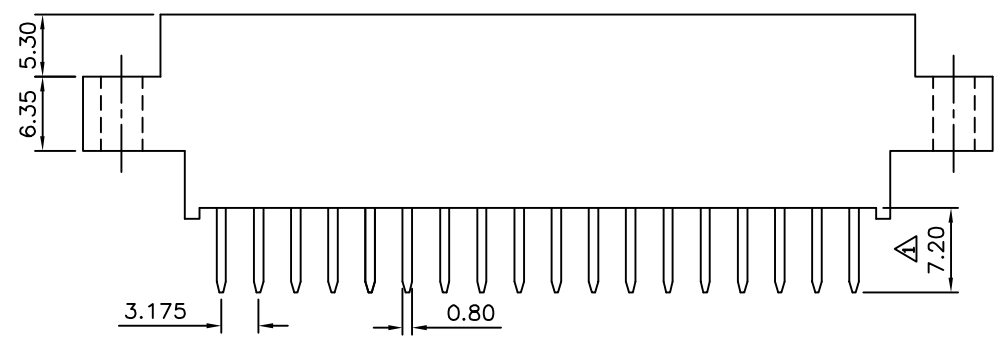
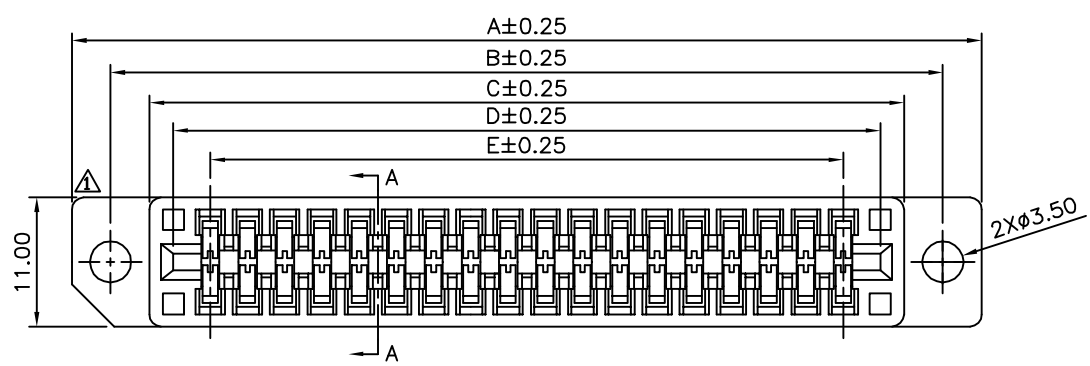

Pin	A	B	C	D	E
30	68.08	61.47	54.52	50.81	44.45
36	77.60	70.99	64.04	60.33	53.97
40	83.95	77.34	70.39	66.68	60.32
44	90.30	83.69	76.74	73.03	66.67
56	109.35	102.74	95.79	92.08	85.72
60	115.70	109.09	102.14	98.43	92.07
72	134.75	128.14	121.19	117.48	111.12
80	147.45	140.84	133.89	130.18	123.82
86	156.97	150.36	143.41	139.71	133.35
100	179.20	172.59	165.64	161.93	155.57

4UCON 元化興業股份有限公司
 4UCON TECHNOLOGY INC.

DRAWING No. 04625

APPROVED BY MEI
 CHECKED BY HZF
 DRAWING BY SONG

SCALE NONE REV. A3

UNLESS OTHERWISE SPECIFIED TOLERANCES ARE
 X. ±0.50
 .X ±0.38
 .XX ±0.25

UNIT mm

NO.	REV.	REVISIONS	CHK	DATE
A3		Modify Data	HZF	03/05/2014
A2		Modify Data	HZF	07/31/2012
A1		Modify Data	HZF	09/01/2009
A0		NEW RELEASE	HZF	