

Recommended P.C.B. Layout (Top View)  
 Recommended PCB Thickness: 1.6mm  
 Tolerance: ±0.05

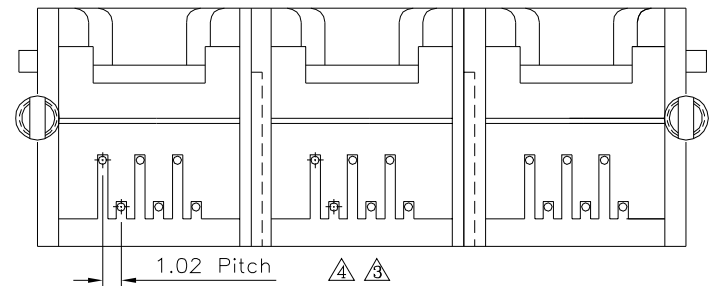
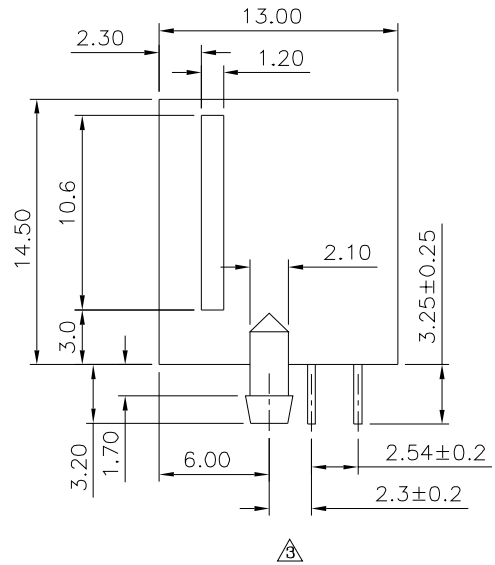
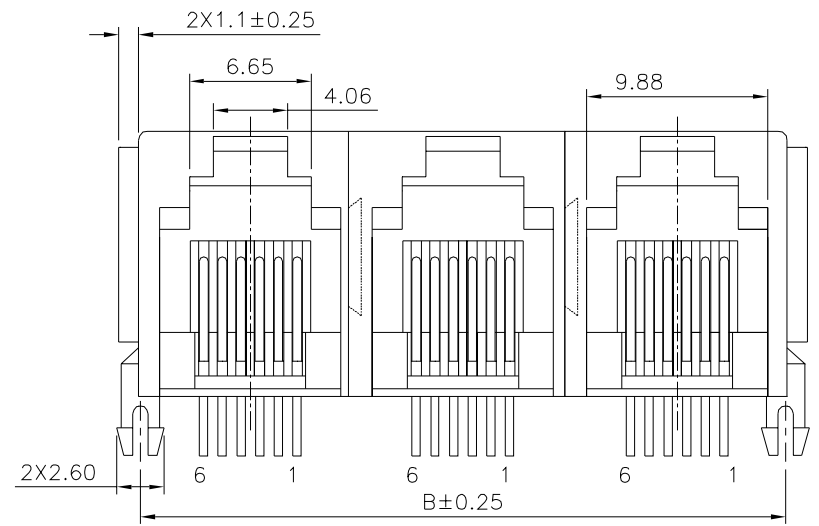

△△△ SPECIFICATION

Current Rating: 1.5A Max.  
 Voltage Rating: 150V AC Max.  
 Operating Temperature: -40°C ~ +85°C  
 Insulation Resistance: 500 Megaohms Min. Initial  
 At 500V DC  
 Contact Resistance: 20 Milliohms Max. Initial  
 Dielectric Withstanding Voltage:  
 1000V RMS. At 60Hz, 1 Minute Between  
 Adjacent Contacts  
 Housing: PBT+G.F. (UL94V-0), Gray  
 △ Contact: Phosphor Bronze  
 Gold Plated 6u" Over All, Over Nickel  
 Cavity Conforms To FCC Rules And Regulations  
 Part 68, Subpart F.  
 RoHS Compliant

△ Pin	A	B	C
02	23.9	23.6	11.65
03	35.55	35.25	23.3
04	47.2	46.9	34.95
05	58.85	58.55	46.6
06	70.5	70.2	58.25
07	82.15	81.85	69.9
08	93.8	93.5	81.55
09	105.45	105.15	93.2
10	117.1	116.8	104.85
11	128.75	128.45	116.5
12	140.4	140.1	128.15

**4UCON** 元化興業股份有限公司  
 4UCON TECHNOLOGY INC.

DRAWING No. △		APPROVED BY		UNLESS OTHERWISE SPECIFIED TOLERANCES ARE .X ±0.25 △.XX ±0.13 .XXX ±0.05
06137		MEI		
		CHECKED BY	HZF	
		DRAWING BY	CYP	
SCALE	NONE	REV.	A4	UNIT mm

NO.	REV.	REVISIONS	CHK	DATE
△	A4	Modify Data	HZF	12/29/2020
△	A3	Modify Data	HZF	04/09/2016
△	A2	Modify Data	HZF	03/25/2013
△	A1	Modify Data	HZF	06/03/2010
△	A0	NEW RELEASE	HZF	07/10/2008