

Recommended P.C.B. Layout

SPECIFICATION

- Current Rating: 3 Amps/Contact Max.
- Contact Resistance: 4 Milliohms/Contact Max.
- Insulation Resistance: 1000 Megaohms Min. At 100V
- Operation Voltage: 60V AC/DC
- Average Insertion Force With Steel Pin Of $\phi 0.43\text{mm}$: <250g
- Average Withdrawal Force With Steel Pin Of $\phi 0.43\text{mm}$: >90g Min.
- Mechanical Life Cycle: 200 Min.
- Operation Temperature: Gold Plated: $-55^{\circ}\text{C} \sim +105^{\circ}\text{C}$
Tin Plated: $-40^{\circ}\text{C} \sim +105^{\circ}\text{C}$
- Pin(Outer Sleeve): Brass
Tin Plated Over Nickel
- Clip(Contact 4 Finger): Beryllium Copper
Gold Flash Over Nickel
- Insulator(Housing): PPS(UL94V-0), Black
RoHS Compliant

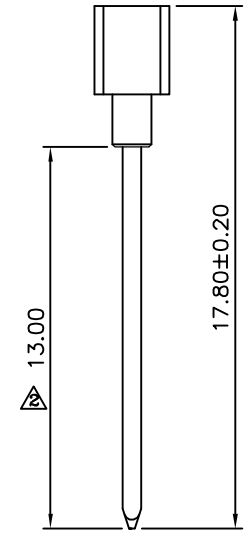
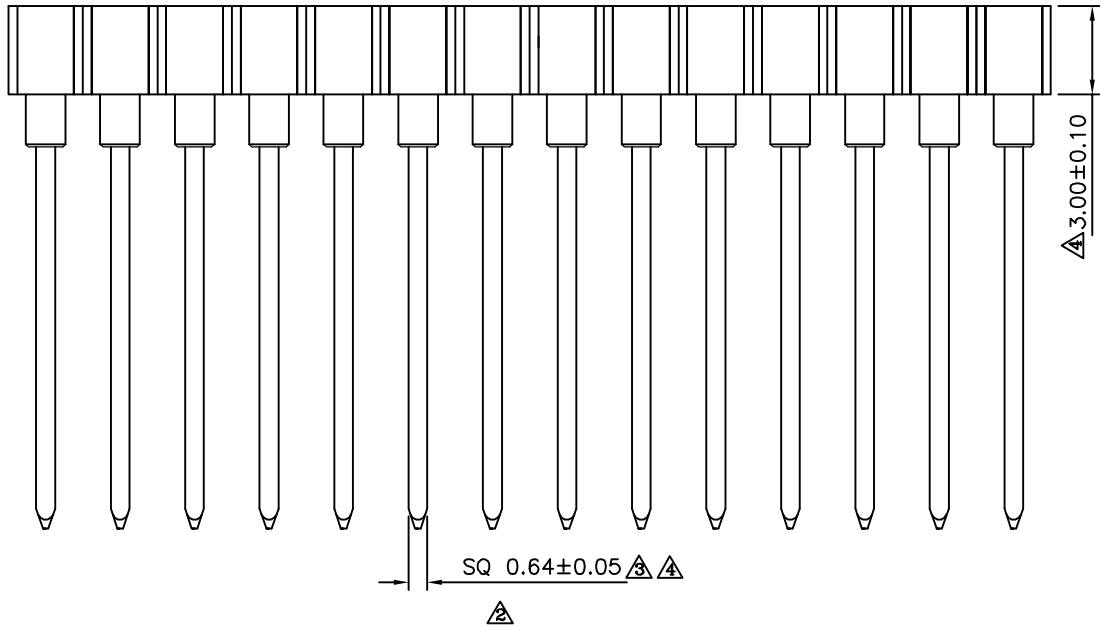
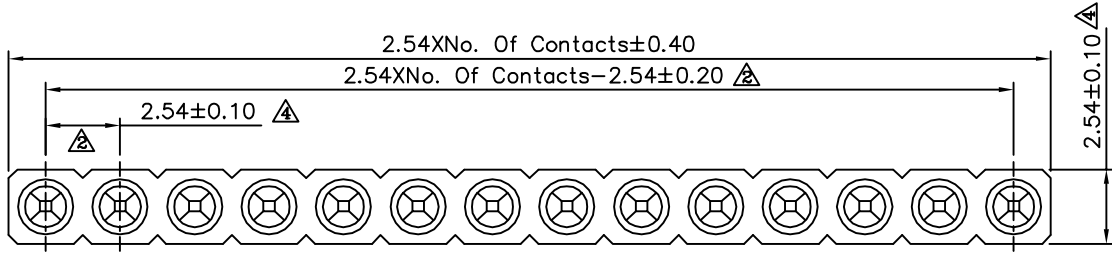

4UCON 元化興業股份有限公司
4UCON TECHNOLOGY INC.

DRAWING No.		APPROVED BY		UNLESS OTHERWISE SPECIFIED TOLERANCES ARE X. ±0.50 X. ±0.30 XX ±0.20 XXX ±0.10 ANG. ±5°
06966		EMILY		
		CHECKED BY HZF		
		DRAWING BY HAO		UNIT mm
SCALE	NONE	REV.	A4	

A4	Modify Data	HZF	09/08/2015
A3	Modify Dim. 0.64-->0.64±0.02	HZF	04/13/2011
A2	Modify Data	HZF	03/22/2011
A1	Modify Spec.	HZF	04/08/2010
A0	NEW RELEASE	BECKY	11/25/2005
NO. REV.	REVISIONS	CHK	DATE