

Applicable FPC/FFC
Thickness: 0.25~0.35mm

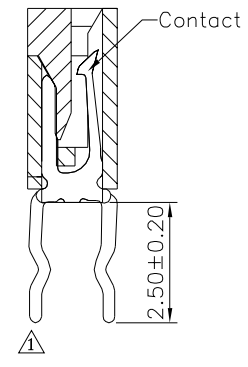
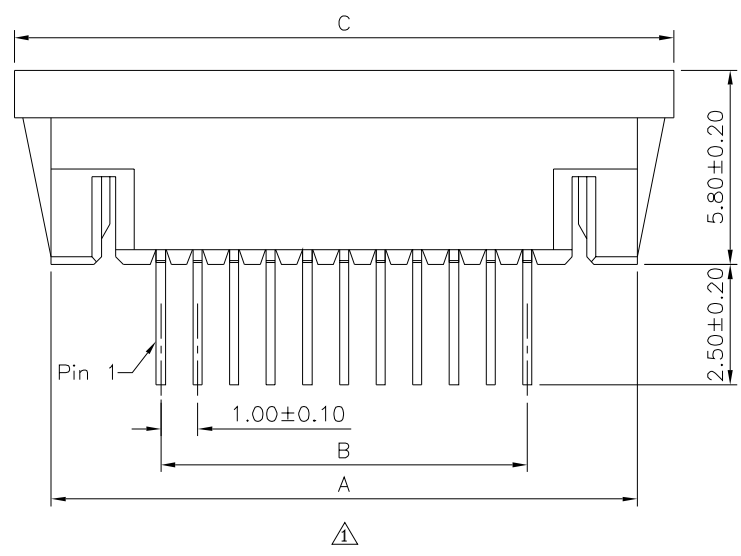
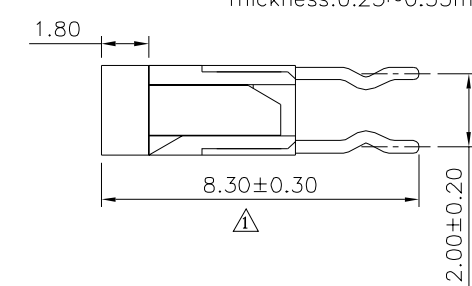
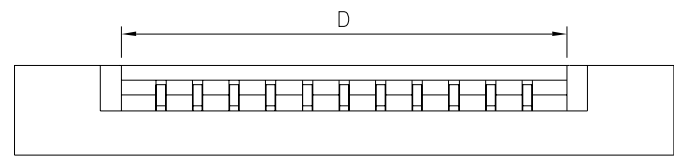

SPECIFICATION
1.General Characteristics
 1.0mm FPC XXP DIP 180° ZIF Single Contact
 Standard Layout Withstand High Temperature
2.Material&Finish
 Base:PA9T(UL94V-0),Ivory
 Slider:PPS(UL94V-0),Black
 Contact:Phosphor Bronze,Tin Plated Over Nickel
3.Electrical Characteristics
 Operating Voltage:100V AC Max.
 Current Rating:0.5 Amp Max.
 Dielectric Withstanding Voltage:500V AC RMS
 Contact Resistance:30 Milliohms Max.
 Insulation Resistance:500 Megaohms Min.
4.Environmental Characteristics
 Operation Temperature:-40°C~+85°C
5.RoHS Compliant

Pin	A±0.20	B±0.15	C±0.20	D±0.08	E±0.15
4	9.00	3.00	11.00	5.15	3.00
5	10.00	4.00	12.00	6.15	4.00
6	11.00	5.00	13.00	7.15	5.00
7	12.00	6.00	14.00	8.15	6.00
8	13.00	7.00	15.00	9.15	7.00
9	14.00	8.00	16.00	10.15	8.00
10	15.00	9.00	17.00	11.15	9.00
11	16.00	10.00	18.00	12.15	10.00
12	17.00	11.00	19.00	13.15	11.00
13	18.00	12.00	20.00	14.15	12.00
14	19.00	13.00	21.00	15.15	13.00
15	20.00	14.00	22.00	16.15	14.00
16	21.00	15.00	23.00	17.15	15.00
17	22.00	16.00	24.00	18.15	16.00
18	23.00	17.00	25.00	19.15	17.00
19	24.00	18.00	26.00	20.15	18.00
20	25.00	19.00	27.00	21.15	19.00
21	26.00	20.00	28.00	22.15	20.00
22	27.00	21.00	29.00	23.15	21.00
23	28.00	22.00	30.00	24.15	22.00
24	29.00	23.00	31.00	25.15	23.00
25	30.00	24.00	32.00	26.15	24.00
26	31.00	25.00	33.00	27.15	25.00
27	32.00	26.00	34.00	28.15	26.00
28	33.00	27.00	35.00	29.15	27.00
29	34.00	28.00	36.00	30.15	28.00
30	35.00	29.00	37.00	31.15	29.00
31	36.00	30.00	38.00	32.15	30.00
32	37.00	31.00	39.00	33.15	31.00
33	38.00	32.00	40.00	34.15	32.00
34	39.00	33.00	41.00	35.15	33.00

4UCON 元化興業股份有限公司
4UCON TECHNOLOGY INC.

DRAWING No.		APPROVED BY		UNLESS OTHERWISE SPECIFIED TOLERANCES ARE X. ±0.25 X.* ±4.0° .X ±0.20 .X.* ±3.0° .XX ±0.10 .XX.* ±2.0° .XXX ±0.05 .XXX.* ±1.0°	
07355		MEI			
		CHECKED BY	HZF		
SCALE		REV.	B1		UNIT

NO.	REV.	REVISIONS	CHK	DATE
△	B1	Modify Data	HZF	03/26/2014
△	B0	NEW RELEASE	HZF	04/02/2012