

Recommended P.C. Board Pattern Dim.

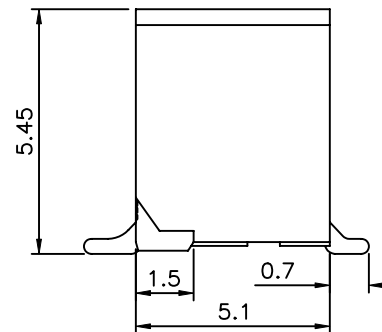
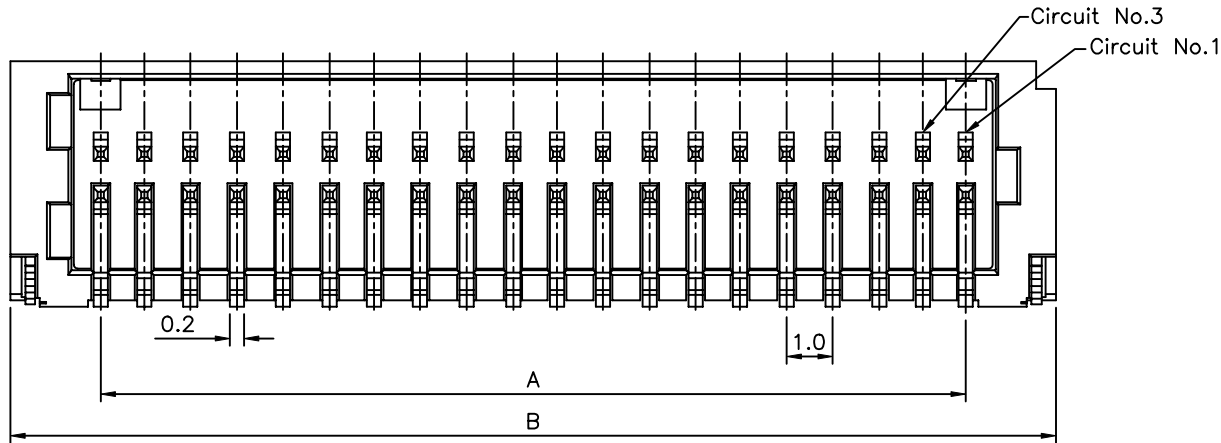
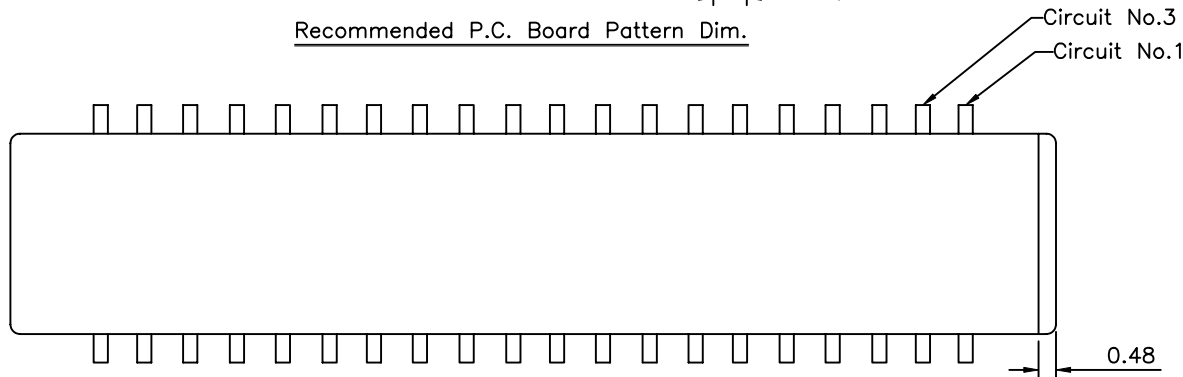

Circuits	A	B
2*10	9.0	13.1
2*15	14.0	18.1
2*20	19.0	23.1
2*25	24.0	28.1

**SPECIFICATION**  
 Current Rating: 1.0A AC/DC(AWG28)  
 Voltage Rating: 50V AC/DC  
 Contact Resistance: Initial Value/20 Milliohms Max.  
 After Environmental Testing/40 Milliohms Max.  
 Insulation Resistance: 100 Megaohms Min.  
 Withstanding Voltage: 500V AC/Minute  
 Temperature Range: -25°C To +85°C  
 Header Contact: Phosphor Bronze  
 Tin Plated, Underplated Nickel  
 Insulator: Glass-Filled Polyamide(UL94V-0)Natura(Ivory)  
 Solder Tad: Brass, Tin Plated, Underplated Copper  
 RoHS Compliant

**4UCON** 元化興業股份有限公司  
 4UCON TECHNOLOGY INC.

DRAWING No.

09893

APPROVED BY

MEI

CHECKED BY

HZF

DRAWING BY

XYH

UNLESS OTHERWISE SPECIFIED TOLERANCES ARE

.X ±0.3  
.XX ±0.2

SCALE NONE

REV.

A1

UNIT mm

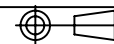

NO. REV.

A1

Modify Data

A0

NEW RELEASE

REVISIONS

CHK

DATE

HZF 07/28/2009