

**△△△ SPECIFICATION**

Current Rating:3 Amp/Contact Max.  
 Operation Voltage:60V AC/DC  
 Contact Resistance:4 Milliohms/Contact Max.  
 Insulation Resistance:1000 Megohms Min. At 100V  
 Average Insertion Force With Steel Pin Of  
 ø0.43mm:<150g  
 Average Withdrawal Force With Steel Pin Of  
 ø0.43mm:>50g Min.  
 Operation Temperature:Gold Plated:-55°C~+105°C  
 Tin Plated:-40°C~+105°C  
 Pin(Outer Sleeve):Brass,Tin Plated Over Nickel  
 Clip(Contact 4 Finger):Beryllium Copper,Heat Treated  
 Gold Flash Over Nickel  
 Insulator:PPS(UL94V-0),Black  
 RoHS Compliant

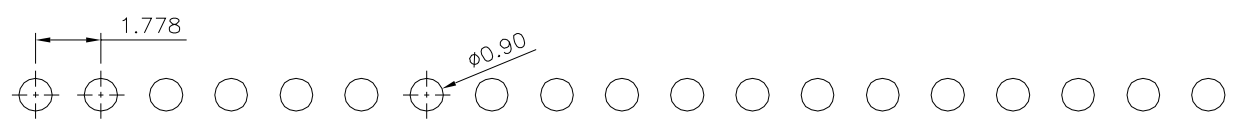

△ Recommended P.C.B. Layout

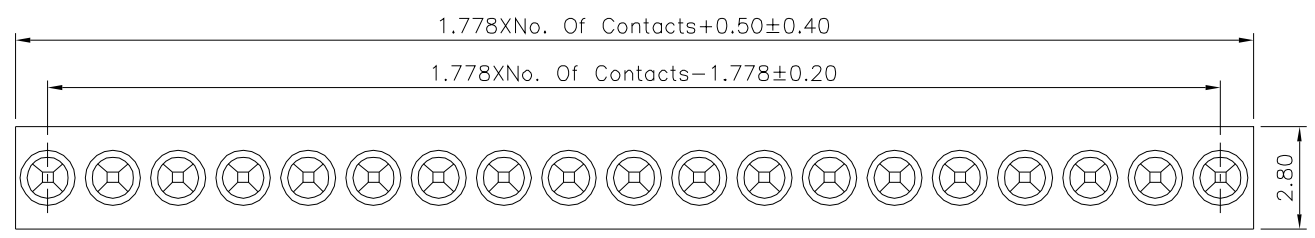

△△

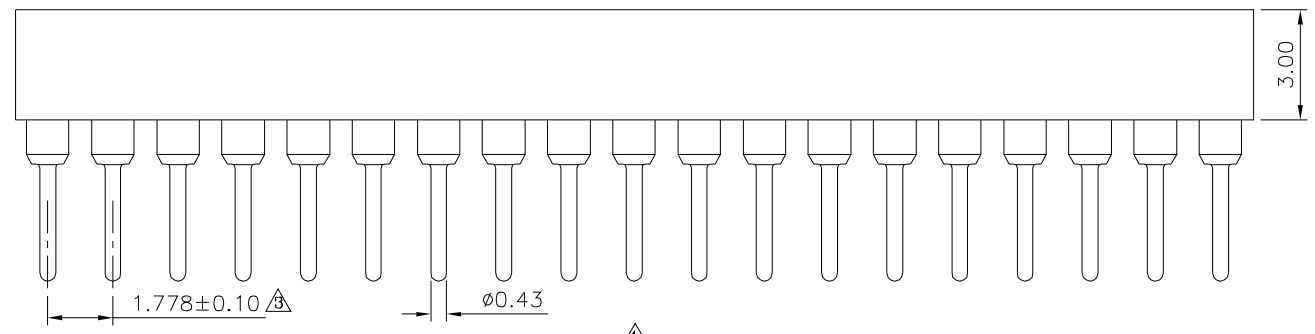

△

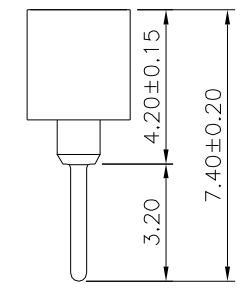

△

**4UCON** 元化興業股份有限公司  
 4UCON TECHNOLOGY INC.

DRAWING No. △△△  
 10116

APPROVED BY MEI  
 CHECKED BY HZF  
 DRAWING BY CYP

SCALE NONE REV. A3

UNLESS OTHERWISE SPECIFIED TOLERANCES ARE  
 X. ±0.50  
 .X ±0.30  
 .XX ±0.20  
 .XXX ±0.10  
 ANG. ±5°  
 UNIT mm

△3	A3	Modify Data	HZF	08/30/2019
△2	A2	Modify Data	HZF	06/01/2013
△1	A1	Modify Data	HZF	03/28/2011
△0	A0	NEW RELEASE	HZF	11/04/2005
NO.	REV.	REVISIONS	CHK	DATE