

△△ SPECIFICATION

Current Rating: 3A(AWG 22#)
 Voltage Rating: 250V AC(RMS)/DC
 Ambient Temperature Range: -25°C~+85°C
 Insulation Resistance: 1000 Megaohms Min. At 500V DC
 Material: PA66(UL94V-0), White
 RoHS Compliant

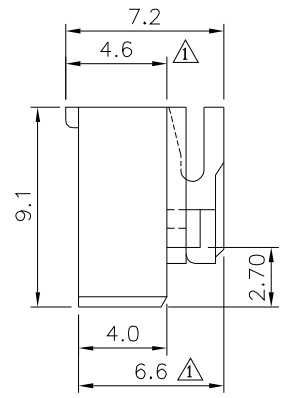
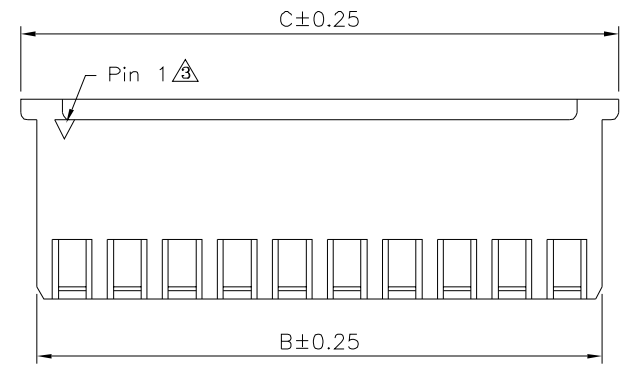
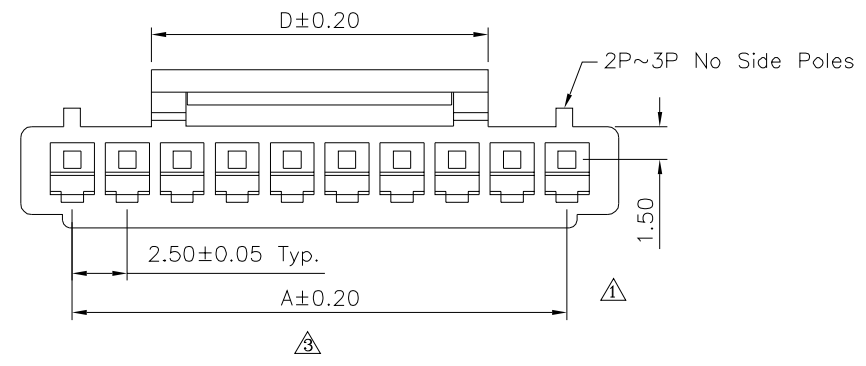

| △ Pin | A | B | C | D |
|-------|-------|------|------|------|
| 02 | 2.50 | 5.6 | 7.2 | 3.0 |
| 03 | 5.00 | 8.2 | 9.7 | 3.0 |
| 04 | 7.50 | 10.7 | 12.2 | 5.3 |
| 05 | 10.00 | 13.2 | 14.7 | 6.5 |
| 06 | 12.50 | 15.7 | 17.2 | 6.5 |
| 07 | 15.00 | 18.2 | 19.7 | 10.3 |
| 08 | 17.50 | 20.7 | 22.2 | 10.3 |
| 09 | 20.00 | 23.2 | 24.7 | 10.3 |
| 10 | 22.50 | 25.7 | 27.2 | 15.3 |
| 11 | 25.00 | 28.2 | 29.7 | 15.3 |
| 12 | 27.50 | 30.7 | 32.2 | 15.3 |
| 13 | 30.00 | 33.2 | 34.7 | 15.3 |
| 14 | 32.50 | 35.7 | 37.2 | 15.3 |
| 15 | 35.00 | 38.2 | 39.7 | 15.3 |

4UCON 元化興業股份有限公司
 4UCON TECHNOLOGY INC.

DRAWING No. △ 11329
 APPROVED BY MEI
 CHECKED BY HZF
 DRAWING BY CYP
 SCALE NONE REV. B3

UNLESS OTHERWISE SPECIFIED TOLERANCES ARE
 .X ±0.25
 .XX ±0.15
 .XXX ±0.08
 UNIT mm

| NO. | REV. | REVISIONS | CHK | DATE |
|-----|------|-------------|-------|------------|
| △ | B3 | Modify Data | HZF | 11/16/2017 |
| △ | B2 | Modify Data | HZF | 10/17/2011 |
| △ | B1 | Modify Data | HZF | 05/08/2010 |
| △ | A0 | NEW RELEASE | BECKY | 11/28/2005 |