

Recommended P.C.B. Layout (Top Side)
(PCB Board Tolerance ±0.05)

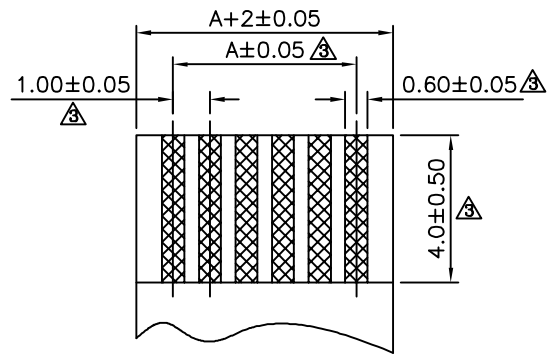

FPC/FFC T=0.30±0.05

- △△ SPECIFICATION**
- 1.General Characteristics**
1.0 FPC XFP SMT 90° NON ZIF Dual Contact
 - 2.Material&Finish**
Housing:PA6T(UL94V-0)
Terminal:Phosphor Bronze,Tin Plated Over Nickel
 - 3.Electrical Characteristics**
Current Rating:0.5 Amp Max.
Voltage Rating:50V AC
Contact Resistance:30 Milliohms Max.(Initial)
50 Milliohms Max.(Final)
Insulation Resistance:500 Megaohms Min.(Initial)
 - 4.Environmental Characteristics**
Withstanding Voltage:500V AC/Minute
Operating Temperature:-20°C~+85°C
 - 5.RoHS Compliant**

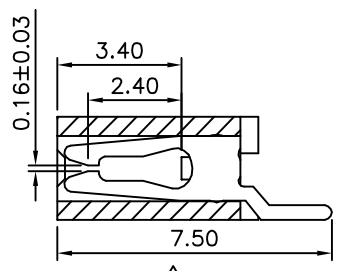
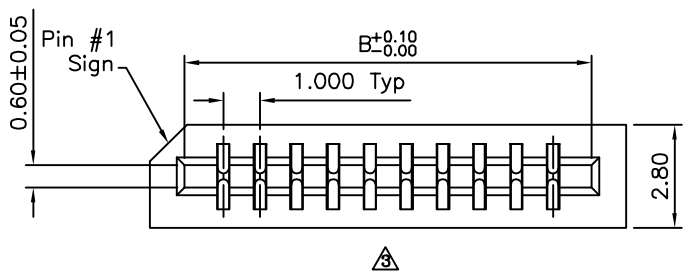
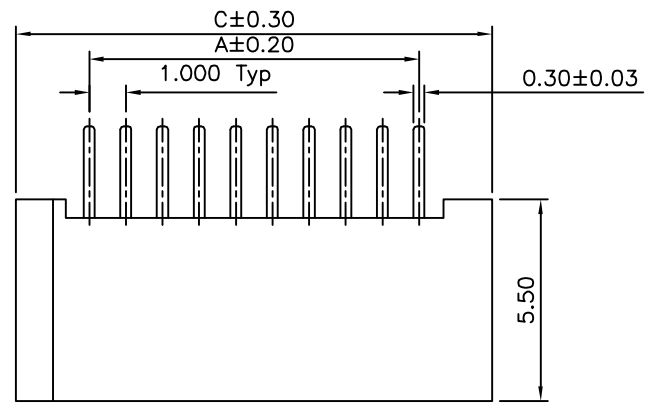

Pin	A	B	C	Pin	A	B	C
3	2.00	4.10	6.00	17	16.00	18.10	20.00
4	3.00	5.10	7.00	18	17.00	19.10	21.00
5	4.00	6.10	8.00	19	18.00	20.10	22.00
6	5.00	7.10	9.00	20	19.00	21.10	23.00
7	6.00	8.10	10.00	21	20.00	22.10	24.00
8	7.00	9.10	11.00	22	21.00	23.10	25.00
9	8.00	10.10	12.00	23	22.00	24.10	26.00
10	9.00	11.10	13.00	24	23.00	25.10	27.00
11	10.00	12.10	14.00	25	24.00	26.10	28.00
12	11.00	13.10	15.00	26	25.00	27.10	29.00
13	12.00	14.10	16.00	27	26.00	28.10	30.00
14	13.00	15.10	17.00	28	27.00	29.10	31.00
15	14.00	16.10	18.00	29	28.00	30.10	32.00
16	15.00	17.10	19.00	30	29.00	31.10	33.00

4UCON 元化興業股份有限公司
4UCON TECHNOLOGY INC.

DRAWING No.		APPROVED BY		UNLESS OTHERWISE SPECIFIED TOLERANCES ARE .X ±0.40 .X ±0.30 .XX ±0.20 .XXX ±0.10
12968		MEI		
		CHECKED BY	HZF	
		DRAWING BY	WSS	
SCALE	NONE	REV.	B3	UNIT mm

NO.	REV.	REVISIONS	CHK	DATE
△	B3	Modify Data	HZF	07/18/2011
△	B2	Modify Data	HZF	04/23/2009
△	B1	Modify Spec.	HZF	01/17/2008
△	B0	NEW RELEASE	HZF	02/10/2006