

Recommended P.C.B. Layout (Top Side)
(PCB Board Tolerance ±0.05)

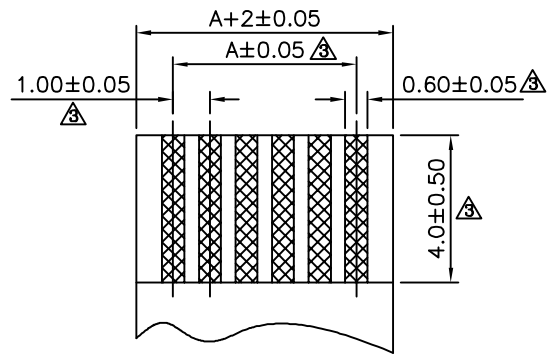

FPC/FFC T=0.30±0.05

△△ SPECIFICATION
1.General Characteristics
 1.0 FPC XFP SMT 90° NON ZIF Dual Contact
2.Material&Finish
 Housing:PA6T(UL94V-0)
 Terminal:Phosphor Bronze,Tin Plated Over Nickel
3.Electrical Characteristics
 Current Rating:0.5 Amp Max.
 Voltage Rating:50V AC
 Contact Resistance:30 Milliohms Max.(Initial)
 50 Milliohms Max.(Final)
 Insulation Resistance:500 Megaohms Min.(Initial)
 Withstanding Voltage:500V AC/Minute
4.Environmental Characteristics
 Operating Temperature:-20°C~+85°C
5.RoHS Compliant

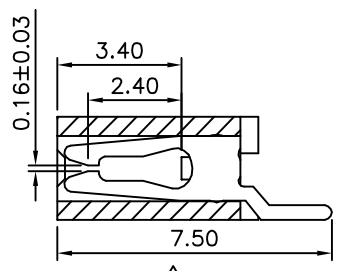
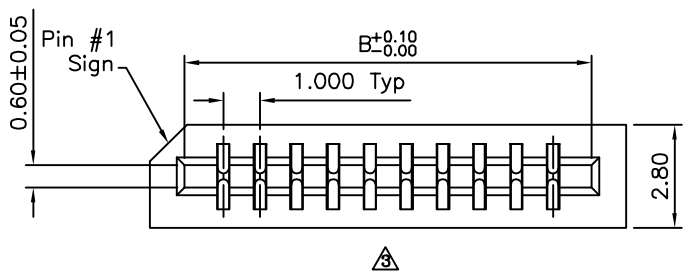
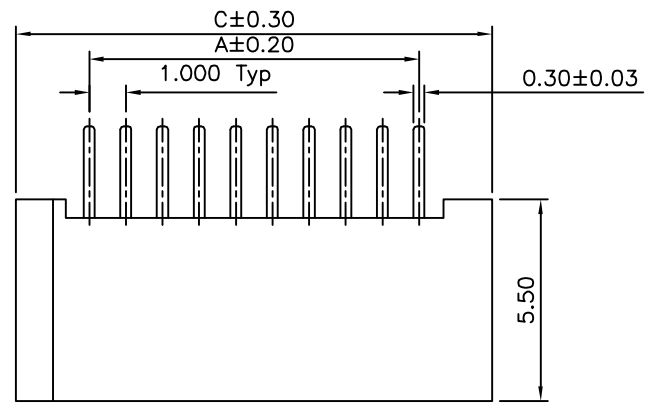

| Pin | A | B | C | Pin | A | B | C |
|-----|-------|-------|-------|-----|-------|-------|-------|
| 3 | 2.00 | 4.10 | 6.00 | 17 | 16.00 | 18.10 | 20.00 |
| 4 | 3.00 | 5.10 | 7.00 | 18 | 17.00 | 19.10 | 21.00 |
| 5 | 4.00 | 6.10 | 8.00 | 19 | 18.00 | 20.10 | 22.00 |
| 6 | 5.00 | 7.10 | 9.00 | 20 | 19.00 | 21.10 | 23.00 |
| 7 | 6.00 | 8.10 | 10.00 | 21 | 20.00 | 22.10 | 24.00 |
| 8 | 7.00 | 9.10 | 11.00 | 22 | 21.00 | 23.10 | 25.00 |
| 9 | 8.00 | 10.10 | 12.00 | 23 | 22.00 | 24.10 | 26.00 |
| 10 | 9.00 | 11.10 | 13.00 | 24 | 23.00 | 25.10 | 27.00 |
| 11 | 10.00 | 12.10 | 14.00 | 25 | 24.00 | 26.10 | 28.00 |
| 12 | 11.00 | 13.10 | 15.00 | 26 | 25.00 | 27.10 | 29.00 |
| 13 | 12.00 | 14.10 | 16.00 | 27 | 26.00 | 28.10 | 30.00 |
| 14 | 13.00 | 15.10 | 17.00 | 28 | 27.00 | 29.10 | 31.00 |
| 15 | 14.00 | 16.10 | 18.00 | 29 | 28.00 | 30.10 | 32.00 |
| 16 | 15.00 | 17.10 | 19.00 | 30 | 29.00 | 31.10 | 33.00 |

4UCON 元化興業股份有限公司
 4UCON TECHNOLOGY INC.

| | | | | |
|-------------|------|-------------|-----|---|
| DRAWING No. | | APPROVED BY | | UNLESS OTHERWISE SPECIFIED TOLERANCES ARE X ±0.40 .X ±0.30 .XX ±0.20 .XXX ±0.10 |
| 12978 | | MEI | | |
| | | CHECKED BY | HZF | |
| | | DRAWING BY | WSS | |
| SCALE | NONE | REV. | B3 | UNIT mm |

| NO. | REV. | REVISIONS | CHK | DATE |
|-----|------|--------------|-----|------------|
| △ | B3 | Modify Data | HZF | 07/18/2011 |
| △ | B2 | Modify Data | HZF | 04/23/2009 |
| △ | B1 | Modify Spec. | HZF | 01/17/2008 |
| △ | B0 | NEW RELEASE | HZF | 02/10/2006 |