

MATERIALS
 Housing: ABS
 Plus: Copper Nickel Plated
 Shield: Stainless, Nickel Plated
 Boot: Eva

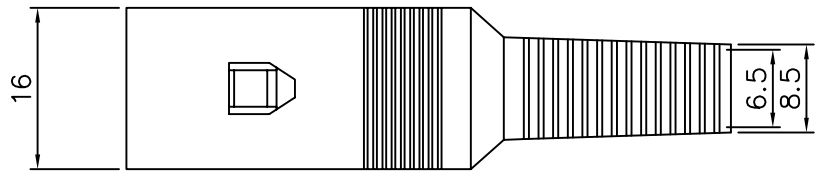
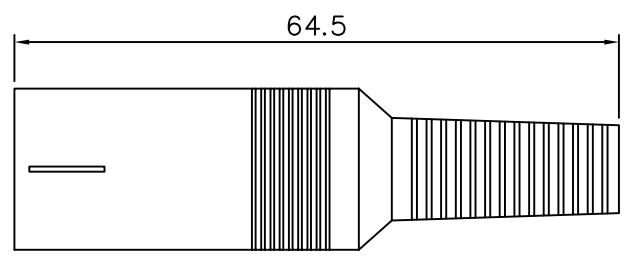
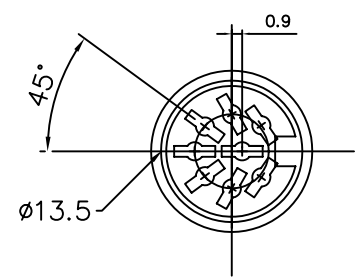

4UCON 元化興業股份有限公司
 4UCON TECHNOLOGY INC.

DRAWING No.
 13146

APPROVED BY MEI
 CHECKED BY BECKY
 DRAWING BY HZF

UNLESS OTHERWISE SPECIFIED TOLERANCES ARE
 ~30 ±0.2
 30~120 ±0.3
 AWG.

SCALE NONE

REV. A0

UNIT mm

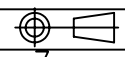

NO.	REV.	REVISIONS	CHK	DATE
0	A0	NEW RELEASE	MEI	