

Recommended P.C.B. Layout

- △ SPECIFICATION**
- Contact Current Rating: 0.5 Amp
 - Dielectric Withstanding Voltage: 250V AC
 - Insulation Resistance: >500 Megaohms/Min.
 - Contact Resistance: 35 Milliohms/Max.
 - △ Operation Temperature: -55°C~+85°C
 - Housing: PA66(UL94V-0),Black
 - Termination Cover: PBT(UL94V-0),Black
 - △ Contacts: Phosphor Bronze, Selective Gold Plated 30u" Over Nickel
 - Shell: Steel, Nickel Plated Over Copper
 - △ Boardlock: Brass, Tin Plated Over Copper
 - Screws: Steel, Nickel Plated Over Copper
 - RoHS Compliant

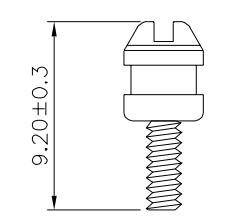
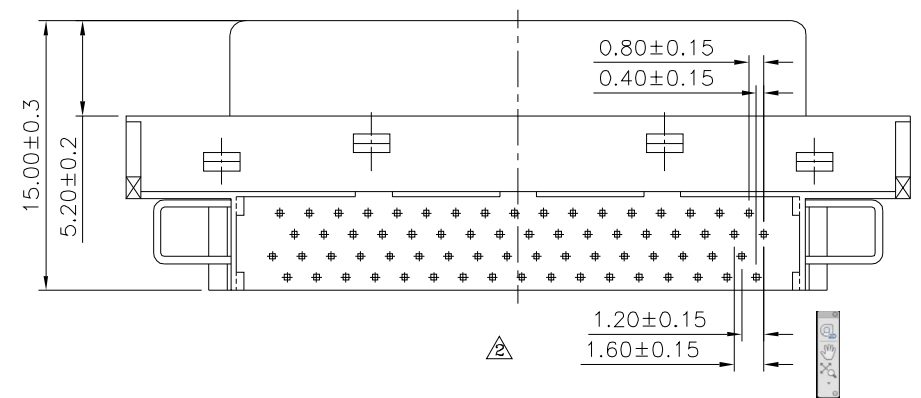
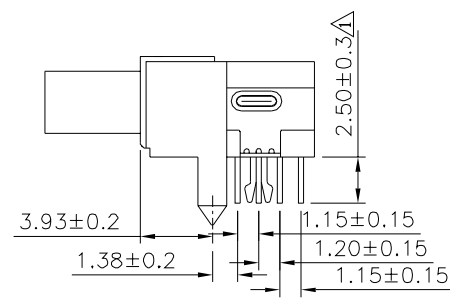
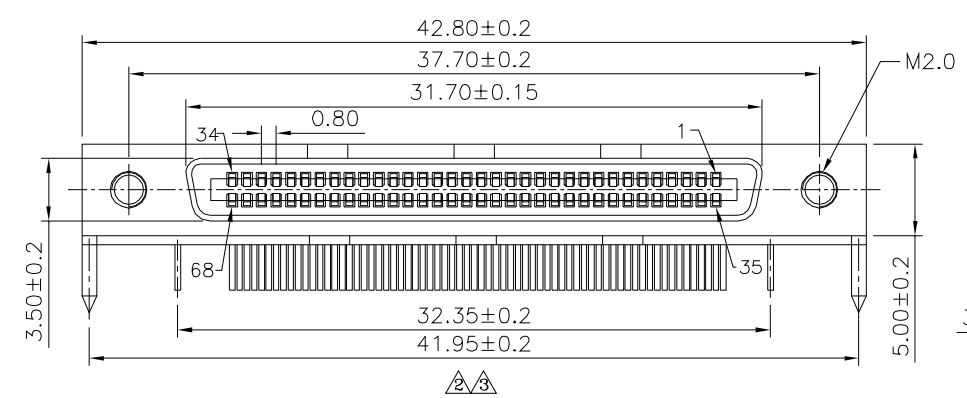

2X Screw Nut

4U CON 元化興業股份有限公司
4U CON TECHNOLOGY INC.

DRAWING No.		APPROVED BY		UNLESS OTHERWISE SPECIFIED TOLERANCES ARE .X ±0.38 .XX ±0.25 ANG.	△ A4	Modify Data	HZF	02/15/2017
15671		MEI			△ A3	Modify Data	HZF	06/20/2014
		CHECKED BY			△ A2	Modify Data	HZF	08/23/2011
SCALE		DRAWING BY		ANG.	△ A1	Modify Data	HZF	05/26/2011
NONE		CYP		UNIT	△ A0	NEW RELEASE	HZF	11/15/2006
REV.		A4		mm	NO. REV.	REVISIONS	CHK	DATE