

Recommended P.C.B. Layout

**△ SPECIFICATION**

Withstand Voltage:500V AC For 1 Minute  
 Contact Resistance:30 Milliohms Max.  
 Insulation Resistance:1000 Megaohms Min.  
 Operation Temperature Range:-55°C~+85°C  
 Contact Insertion Force:0.115Kg Max. Per Contact Pair  
 Contact Withdrawal Force:0.015Kg Min. Per Contact Pair  
 Terminal Retention Force(In Housing):0.5Kg Min. Per Terminal  
 △ Housing:PA66(UL94V-0),Black  
 △ Contact:Brass  
 Gold Flash On Contact Area  
 Tin Plated On Solder Tails,Over Nickel  
 RoHS Compliant

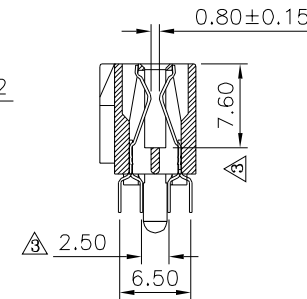
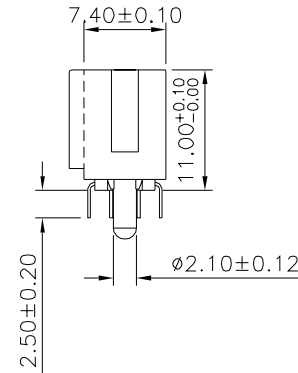
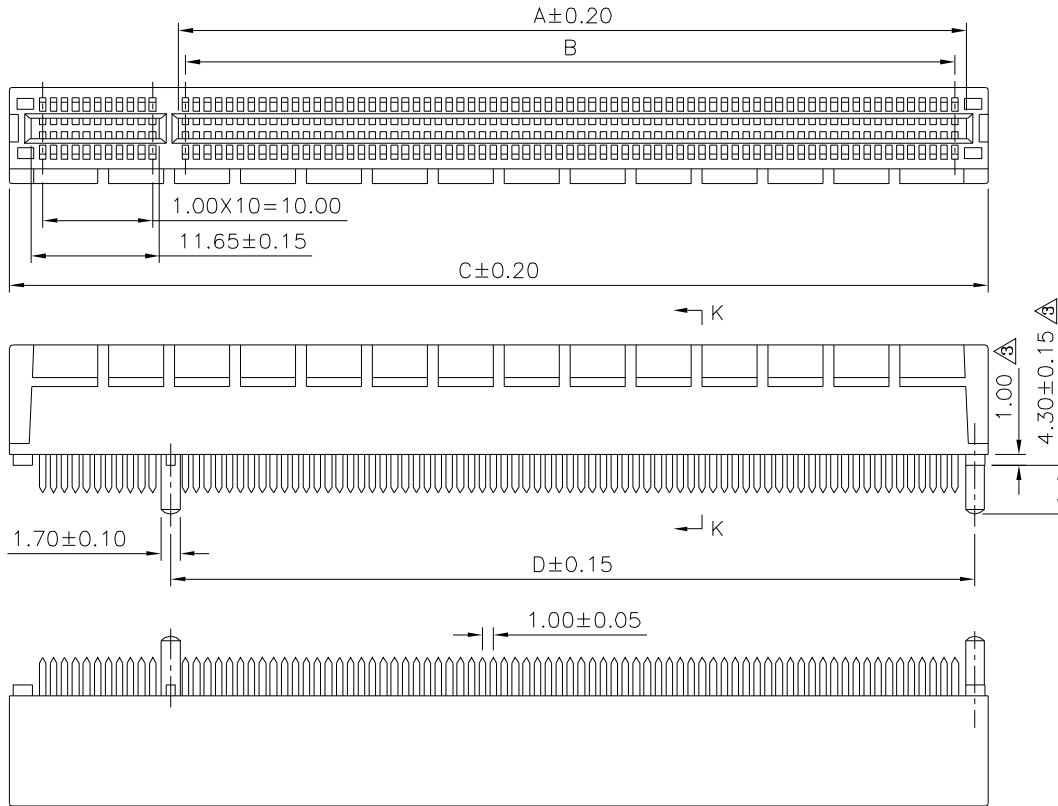

Section K-K

| Pin | A     | B     | C     | D     |
|-----|-------|-------|-------|-------|
| 36  | 7.65  | 6.00  | 25.00 | 9.15  |
| 64  | 21.65 | 20.00 | 39.00 | 23.15 |
| 98  | 38.65 | 37.00 | 56.00 | 40.15 |
| 164 | 71.65 | 70.00 | 89.00 | 73.15 |

**4UCON** 元化興業股份有限公司  
 4UCON TECHNOLOGY INC.

DRAWING No. **16131**

APPROVED BY MEI  
 CHECKED BY HZF  
 DRAWING BY CYP

UNLESS OTHERWISE SPECIFIED TOLERANCES ARE  
 .X  $\pm 0.20$   
 .XX  $\pm 0.10$   
 .XXX  $\pm 0.001$   
 ANG.  $\pm 3^\circ$

| NO.  | REV. | REVISIONS   | CHK | DATE       |
|------|------|-------------|-----|------------|
| △ A3 |      | Modify Data | HZF | 11/27/2019 |
| △ A2 |      | Modify Data | HZF | 02/22/2012 |
| △ A1 |      | Modify Data | HZF | 05/20/2011 |
| △ A0 |      | NEW RELEASE | HZF | 07/07/2008 |

SCALE NONE

REV. A3

UNIT mm

