

△△ SPECIFICATION

Current Rating: 3 Amps/Contact Max.
 Contact Resistance: 4 Milliohms Max./Contact
 Insulation Resistance: 1000 Megaohms Min. At 100V
 Operating Voltage: 60V AC/DC
 Operation Temperature: -40°C~+105°C
 Pin(Outer Sleeve): Brass, Tin Plated Over All, Over Nickel
 Insulator: PPS(UL94V-0), Black
 RoHS Compliant

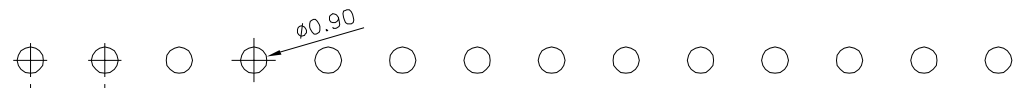

△ Recommended P.C.B. Layout

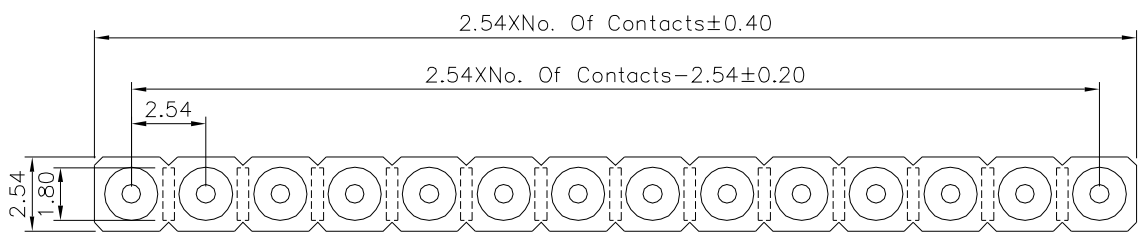

△

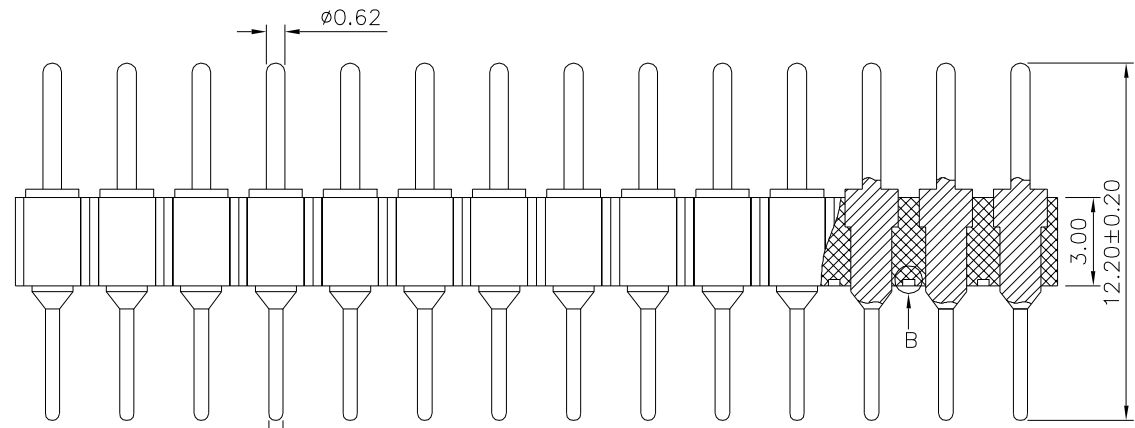

△

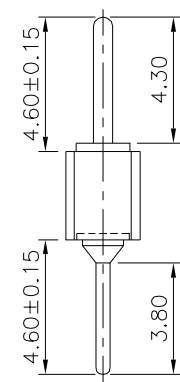

△

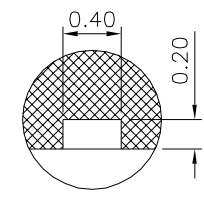

△ Detail: B

4UCON 元化興業股份有限公司
 4UCON TECHNOLOGY INC.

DRAWING No. 16686

APPROVED BY MEI
 CHECKED BY HZF
 DRAWING BY CYP

UNLESS OTHERWISE SPECIFIED TOLERANCES ARE
 X. ±0.50
 .X ±0.30
 .XX ±0.20
 .XXX ±0.10
 ANG. ±5°

NO.	REV.	REVISIONS	CHK	DATE
3	A3	Modify Data	HZF	12/14/2017
2	A2	Modify Data	HZF	03/17/2011
1	A1	Modify Data	BECKY	05/05/2006
0	A0	NEW RELEASE	BECKY	07/20/2005

SCALE NONE REV. A3

