

△△SPECIFICATION

Current Rating: 3 Amps/Contact Max.
 Contact Resistance: 4 Milliohms Max./Contact
 Insulation Resistance: 1000 Megaohms Min. At 100V
 Operating Voltage: 60V AC/DC
 Operation Temperature: -40°C~+105°C
 Pin(Outer Sleeve): Brass, Tin Plated Over All, Over Nickel
 Insulator: PPS(UL94V-0), Black
 RoHS Compliant

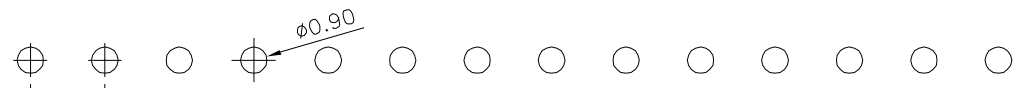

△ Recommended P.C.B. Layout

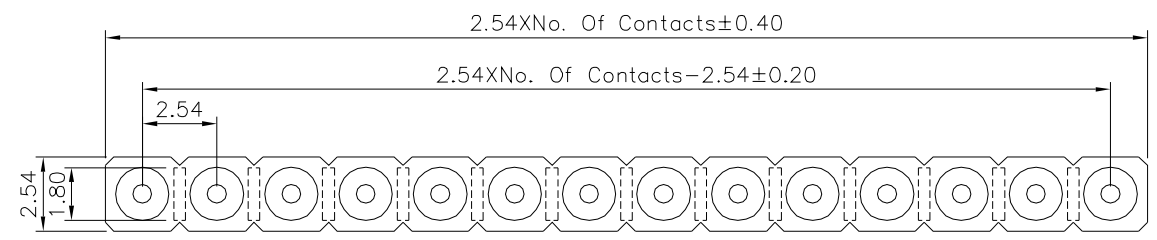

△

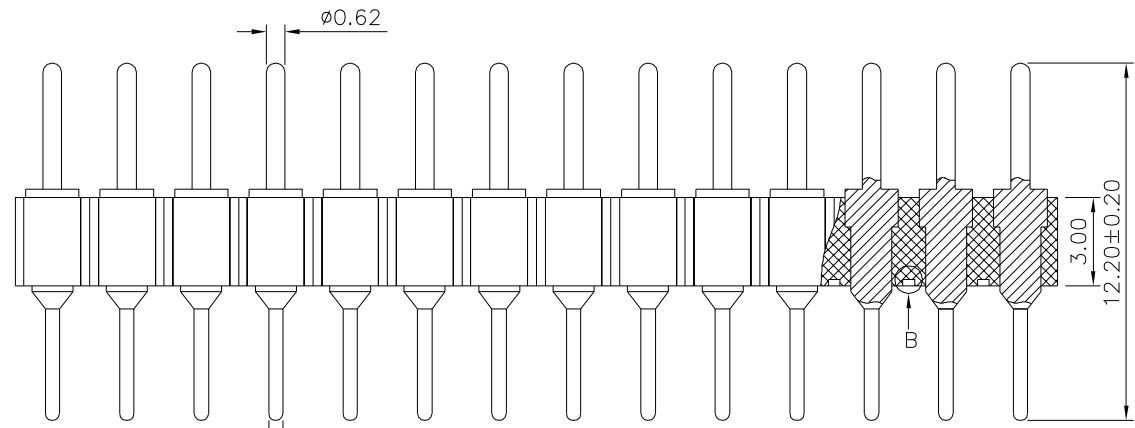

△

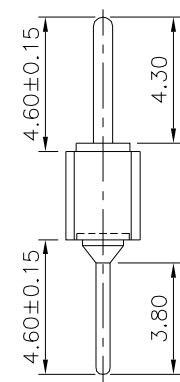

△

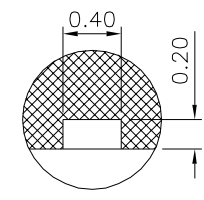

△ Detail: B

4UCON 元化興業股份有限公司
 4UCON TECHNOLOGY INC.

DRAWING No.		APPROVED BY		UNLESS OTHERWISE SPECIFIED TOLERANCES ARE X. ±0.50 △. ±0.30 .XXX ±0.20 .XXX ±0.10 ANG. ±5°	
16692		MEI			
		CHECKED BY	HZF		
		DRAWING BY	CYP		
SCALE	NONE	REV.	A3	UNIT	mm

NO.	REV.	REVISIONS	CHK	DATE
3	A3	Modify Data	HZF	12/14/2017
2	A2	Modify Data	HZF	03/17/2011
1	A1	Modify Data	BECKY	05/05/2006
0	A0	NEW RELEASE	BECKY	07/20/2005