

Recommended P.C.B Layout

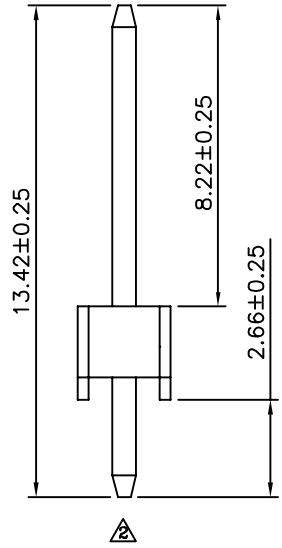
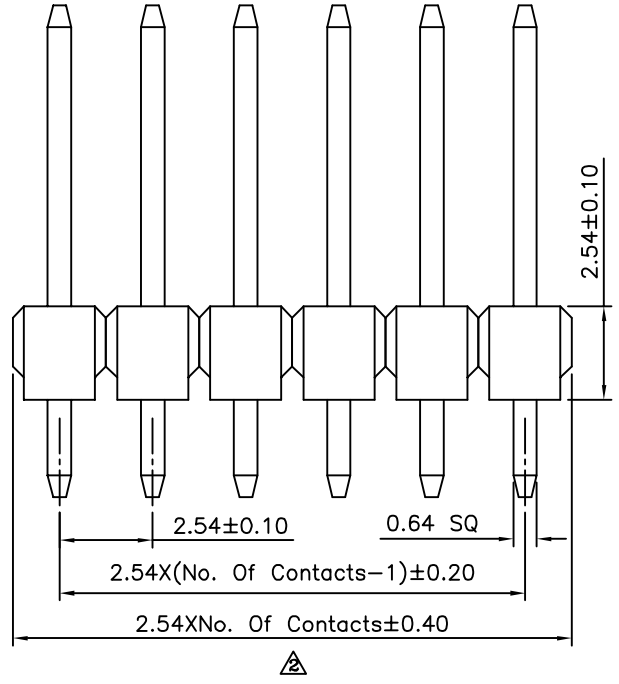
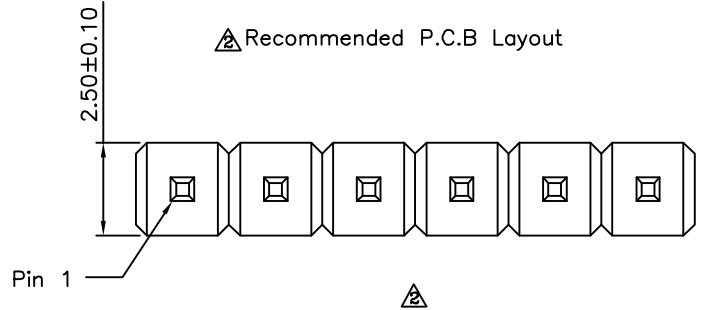

△ SPECIFICATION

Current:3A
Withstanding Voltage:1000V AC RMS
Contact Resistance:20 Milliohms Max.
Insulation Resistance:1000 Megaohms Min.
Operation Temperature:-55°C~+105°C
△ Insulator:PBT+30%G.F.(UL94V-0),Black
Contact:Brass,Gold Flash Over Nickel
No. Of Contacts:2~40 Contacts
RoHS Compliant

4UCON 元化興業股份有限公司
4UCON TECHNOLOGY INC.

| | | | | |
|-------------|------|-------------|----|--|
| DRAWING No. | | APPROVED BY | | UNLESS OTHERWISE SPECIFIED TOLERANCES ARE △ .X ±0.38 △ .XX ±0.25 ANG. ±5° |
| 17718 | | EMILY | | |
| | | CHECKED BY | | |
| | | HZF | | |
| | | DRAWING BY | | |
| | | CYP | | |
| SCALE | NONE | REV. | A3 | UNIT mm |

| | | | | |
|------|------|-------------|------|------------|
| NO. | REV. | REVISIONS | CHK | DATE |
| △ A3 | | Modify Data | HZF | 08/28/2015 |
| △ A2 | | Modify Data | HZF | 09/07/2012 |
| △ A1 | | Modify Data | HZF | 11/13/2008 |
| △ A0 | | NEW RELEASE | SHIN | 03/14/2006 |