

Recommended P.C.B. Layout (Top View)
(PCB Board Tolerance ±0.05)

SPECIFICATION

Current Rating: 3A
 Withstand Voltage: 1000V AC
 Contact Resistance: 20 Milliohms Max.
 Insulation Resistance: 1000 Megohms Min.
 Operating Temperature: -40°C ~ +105°C
 Insulator: PA6T(UL94V-0), Black
 Contact: Brass, Gold Flash Over Nickel
 RoHS Compliant

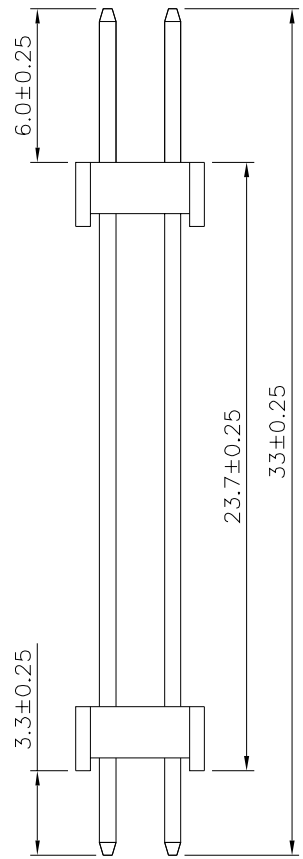
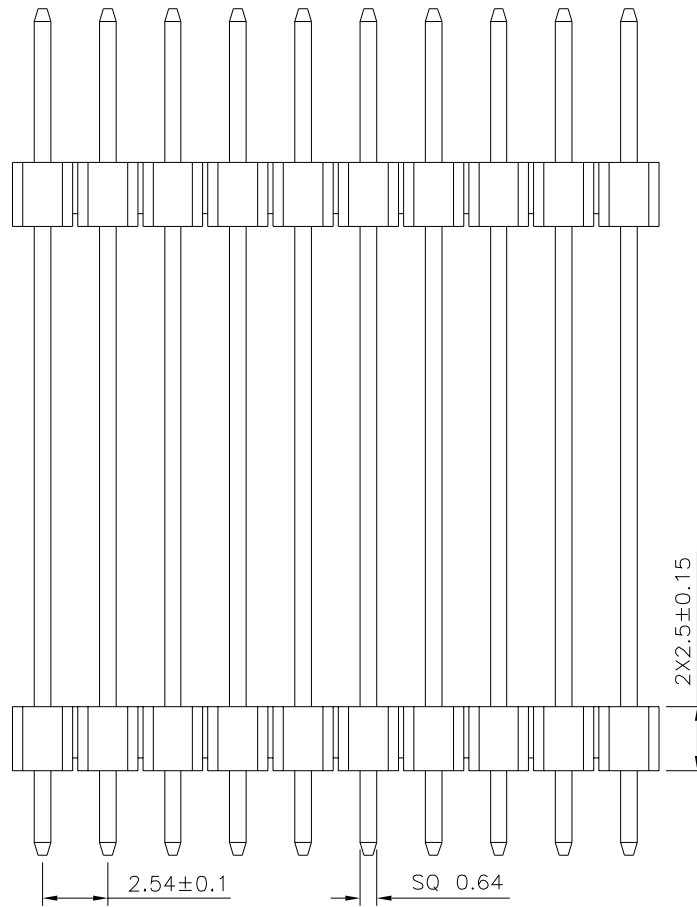

4UCON 元化興業股份有限公司
 4UCON TECHNOLOGY INC.

DRAWING No.		APPROVED BY		UNLESS OTHERWISE SPECIFIED TOLERANCES ARE
17732		MEI		
		CHECKED BY		
SCALE		DRAWING BY		X: ±0.25 X': ±2"
NONE		CYP		.X: ±0.20 X': ±1.5"
REV.		A0		.XX: ±0.15 X': ±1"
UNIT		mm		.XXX: ±0.10 XXX': ±0.5"

NO.	REV.	REVISIONS	CHK	DATE
△ A0		NEW RELEASE	HZF	04/30/2017