

**SPECIFICATION**

Current Rating:1.0 Amp  
 Withstand Voltage:500V AC/DC  
 Contact Resistance:20 Milliohms Max.  
 Insulation Resistance:1000 Megaohms Min.  
 Operation Temperature:-40°C~+105°C  
 Insulator:LCP+30%G.F.(UL94V-0),Black  
 Contact:Phosphor Bronze,Matte Tin Plated Over Nickel  
 RoHS Compliant

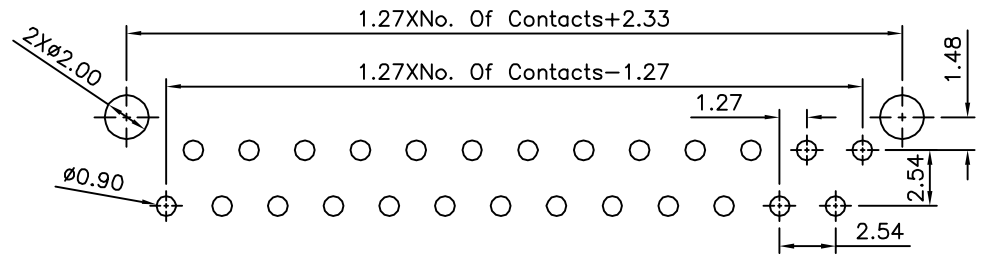

Recommended P.C.B. Layout(Top Side)  
 (PCB Board Tolerance±0.05)

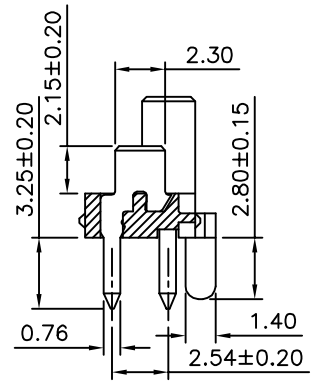
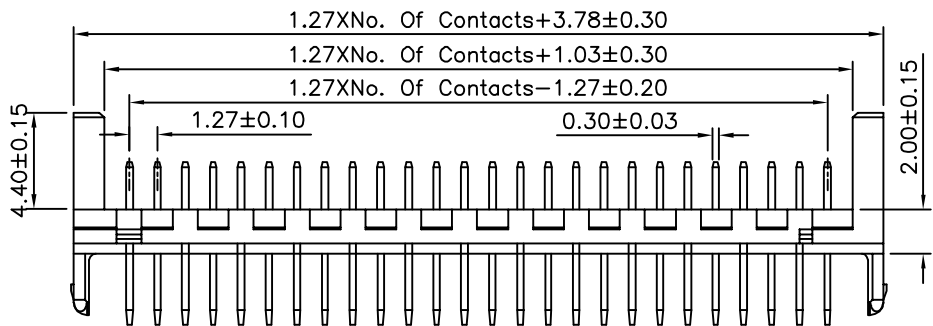
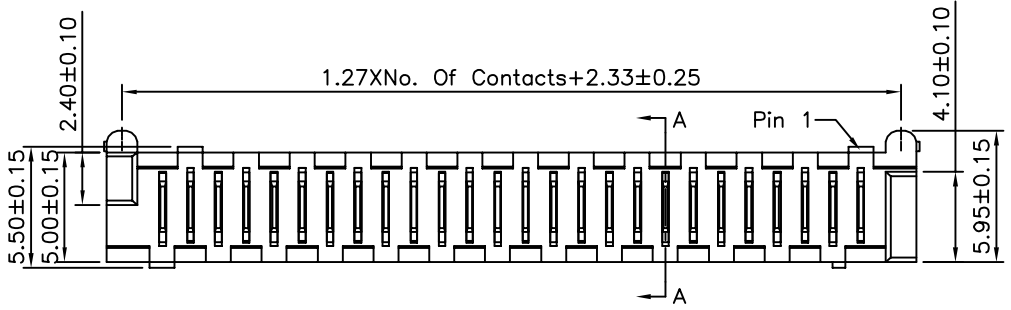

Section A-A

**4UCON** 元化興業股份有限公司  
 4UCON TECHNOLOGY INC.

DRAWING No.		APPROVED BY		UNLESS OTHERWISE SPECIFIED TOLERANCES ARE .X ±0.40 .XX ±0.25 .XXX ±0.15 ANG. ±3°
17771		EMILY		
		CHECKED BY		
		HZF		
		DRAWING BY		UNIT mm
		SONG		
SCALE	NONE	REV.	A1	NO. REV.

△ A1	Modify Data	HZF	12/27/2013
△ A0	NEW RELEASE	HZF	06/10/2012
NO. REV.	REVISIONS	CHK	DATE