

Recommended P.C.B. Layout

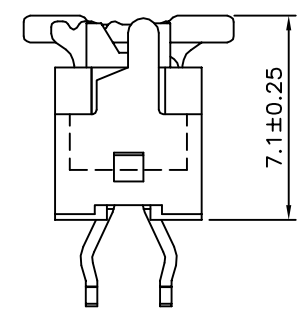

Mating Height Draw

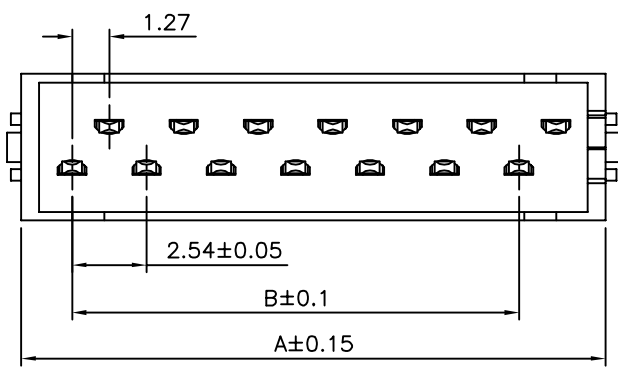
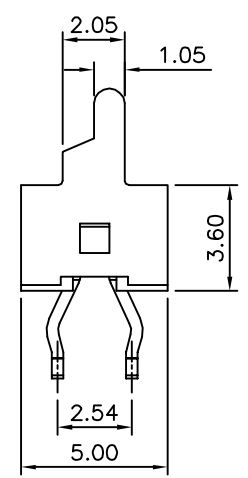
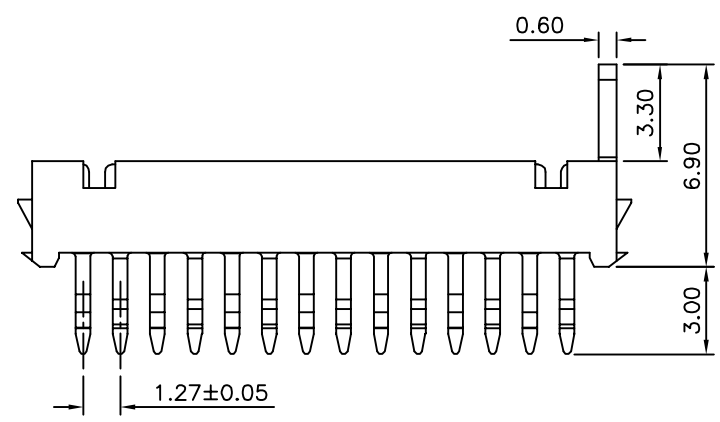

△ SPECIFICATION
 Current Rating:1.0A AC/DC
 Voltage Rating:30V AC/DC
 Contact Resistance:20 Milliohms Max.
 Insulation Resistance:1000 Megaohms Min.
 Withstanding Voltage:500V AC/Minute
 Operation Temperature Range:-40°C~+105°C
 Insulator:PA46(UL94V-0)
 Contact:Phosphor Bronze,Tin Plated Over Nickel
 RoHS Compliant

△

| Pin | A | B |
|-----|-------|-------|
| 04 | 7.20 | 2.54 |
| 06 | 9.74 | 5.08 |
| 08 | 12.28 | 7.62 |
| 10 | 14.82 | 10.16 |
| 12 | 17.36 | 12.70 |
| 14 | 19.90 | 15.24 |
| 16 | 22.44 | 17.78 |
| 18 | 24.98 | 20.32 |
| 20 | 27.52 | 22.86 |
| 22 | 30.06 | 25.40 |
| 24 | 32.60 | 27.94 |
| 26 | 35.14 | 30.48 |

4UCON 元化興業股份有限公司
 4UCON TECHNOLOGY INC.

| | | | | |
|-------------|------|-------------|----|---|
| DRAWING No. | | APPROVED BY | | UNLESS OTHERWISE SPECIFIED TOLERANCES ARE .X ±0.2 .XX ±0.15 ANG. |
| 18174 | | EMILY | | |
| | | CHECKED BY | | |
| | | HZF | | |
| | | DRAWING BY | | |
| | | SONG | | |
| SCALE | NONE | REV. | A1 | UNIT mm |

| | | | | |
|------|------|-------------|-------|------------|
| NO. | REV. | REVISIONS | CHK | DATE |
| △ A1 | | Modify Data | HZF | 11/09/2012 |
| △ A0 | | NEW RELEASE | BECKY | 02/15/2005 |