

Recommended P.C.B. Layout

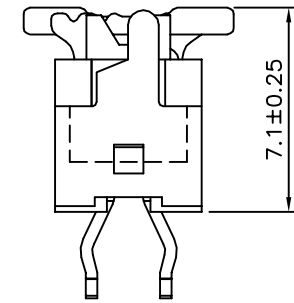

Mating Height Draw

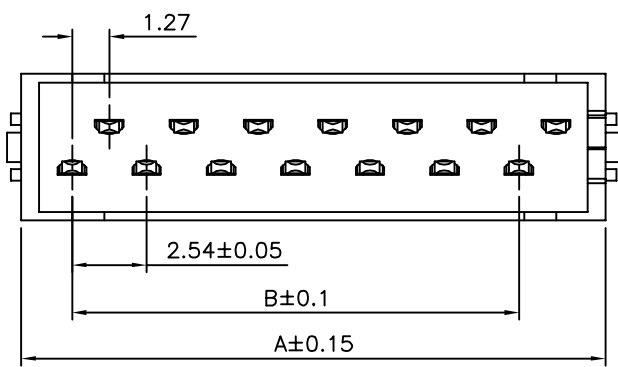
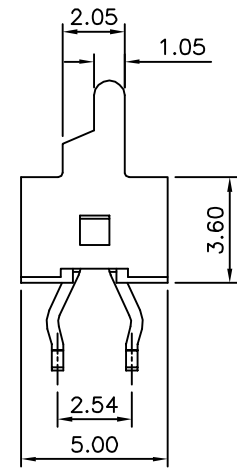
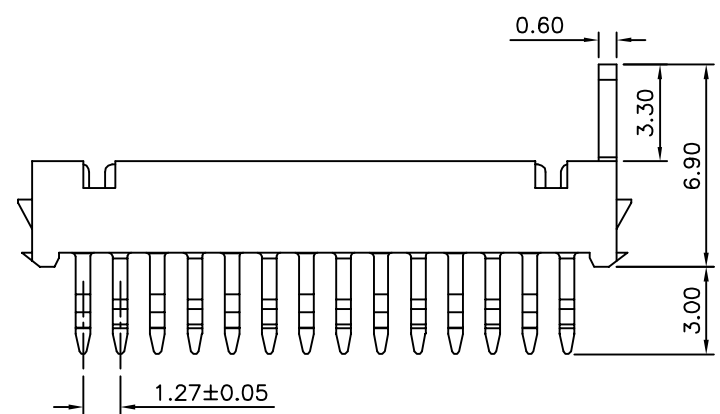

△ SPECIFICATION
 Current Rating:1.0A AC/DC
 Voltage Rating:30V AC/DC
 Contact Resistance:20 Milliohms Max.
 Insulation Resistance:1000 Megaohms Min.
 Withstanding Voltage:500V AC/Minute
 Operation Temperature Range:-40°C~+105°C
 Insulator:PA46(UL94V-0)
 Contact:Phosphor Bronze,Tin Plated Over Nickel
 RoHS Compliant

Pin	A	B
04	7.20	2.54
06	9.74	5.08
08	12.28	7.62
10	14.82	10.16
12	17.36	12.70
14	19.90	15.24
16	22.44	17.78
18	24.98	20.32
20	27.52	22.86
22	30.06	25.40
24	32.60	27.94
26	35.14	30.48

4UCON 元化興業股份有限公司
 4UCON TECHNOLOGY INC.

DRAWING No.		APPROVED BY		UNLESS OTHERWISE SPECIFIED TOLERANCES ARE .X ±0.2 .XX ±0.15 ANG.
18175		EMILY		
		CHECKED BY		
		HZF		
		DRAWING BY		
		SONG		
SCALE	NONE	REV.	A1	UNIT mm

NO.	REV.	REVISIONS	CHK	DATE
△ A1		Modify Data	HZF	11/09/2012
△ A0		NEW RELEASE	BECKY	02/15/2005