

Recommended P.C.B. Layout

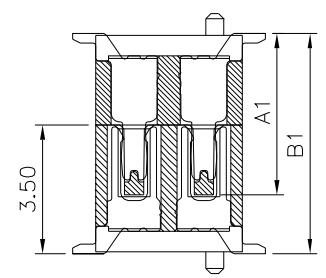
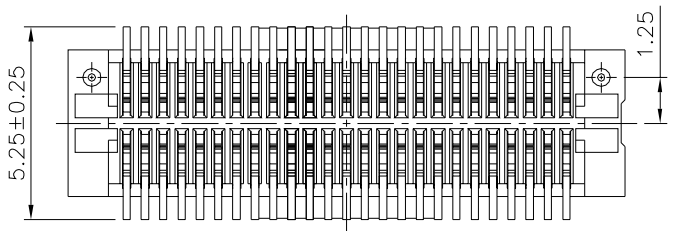
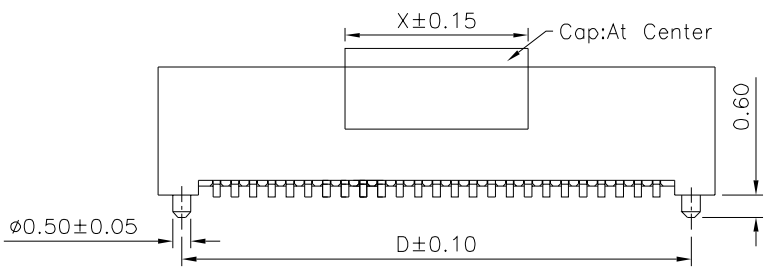
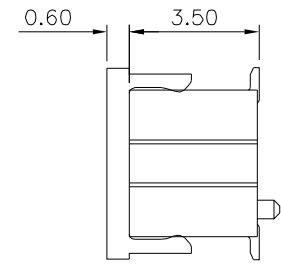
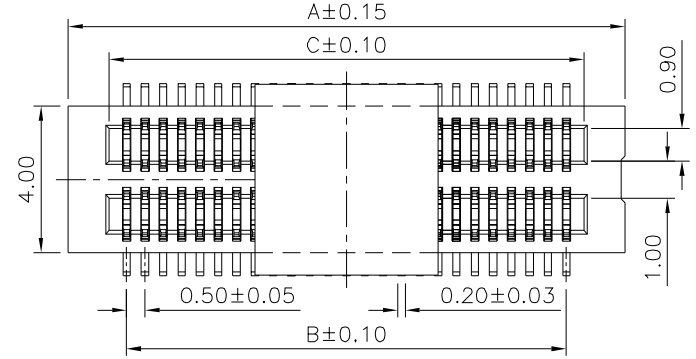

Mating Draw (Ref.)

**SPECIFICATION**

1. **General Characteristics:**  
0.5mm Board To Board Double Slot Type Male XXP  
SMT 180° With Post Stacking Height=6.0mm With Cap
2. **Material&Finish:**  
Housing:LCP(UL94V-0),White  
Contact:Phosphor Bronze,Gold Plated Over Nickel
3. **Electrical Characteristics:**  
Current Rating:0.5A AC/DC  
Voltage Rating:50V AC/DC  
Withstanding Voltage:100V AC For One Minute  
Contact Resistance:30 Milliohms Max.  
Insulation Resistance:100 Megaohms Min. At 100V DC
4. **Environmental Characteristics:**  
Operation Temperature Range:-20°C~+105°C
5. **RoHS Compliant**

Type X:

| Type | Pin    | Dim.(mm) |
|------|--------|----------|
| 1    | 10~48  | 5.00     |
| 2    | 50~120 | 12.0     |

| Part No.(Socket) | Part No.(Plug) | A1   | B1   |
|------------------|----------------|------|------|
| 1660             | 1661           | 4.40 | 6.00 |

| Pin | A     | B     | C     | D     |
|-----|-------|-------|-------|-------|
| 10  | 5.20  | 2.00  | 2.96  | 3.90  |
| 14  | 6.20  | 3.00  | 3.96  | 4.90  |
| 20  | 7.70  | 4.50  | 5.46  | 6.40  |
| 30  | 10.20 | 7.00  | 7.96  | 8.90  |
| 40  | 12.70 | 9.50  | 10.46 | 11.40 |
| 50  | 15.20 | 12.00 | 12.96 | 13.90 |
| 60  | 17.70 | 14.50 | 15.46 | 16.40 |
| 70  | 20.20 | 17.00 | 17.96 | 18.90 |
| 80  | 22.70 | 19.50 | 20.46 | 21.40 |
| 90  | 25.20 | 22.00 | 22.96 | 23.90 |
| 100 | 27.70 | 24.50 | 25.46 | 26.40 |
| 120 | 32.70 | 29.50 | 30.46 | 31.40 |

**4UCON** 元化興業股份有限公司  
4UCON TECHNOLOGY INC.

|             |    |                |      |   |
|-------------|----|----------------|------|---|
| DRAWING No. |    | APPROVED BY    |      | UNLESS OTHERWISE SPECIFIED TOLERANCES ARE<br>.X ±0.2<br>.XX ±0.15 |
| 19024       |    | MEI            |      |   |
|             |    | CHECKED BY HZF |      |   |
| SCALE       |    | DRAWING BY     |      | UNIT mm   |
| NONE        |    | CYP            |      |   |
| REV.        | BO | NO.            | REV. | DATE  |
|             |    |                |      |   |

|      |             |     |            |
|------|-------------|-----|------------|
| △ BO | NEW RELEASE | HZF | 09/25/2018 |
| NO.  | REVISIONS   | CHK | DATE       |
|      |             |     |            |