

Recommended P.C.B. Layout

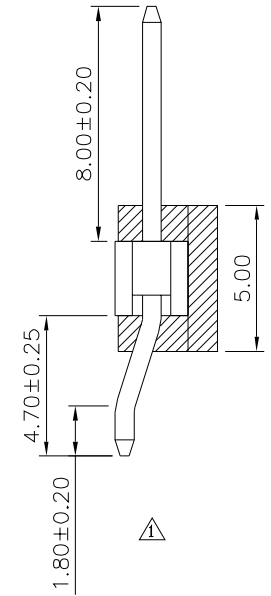
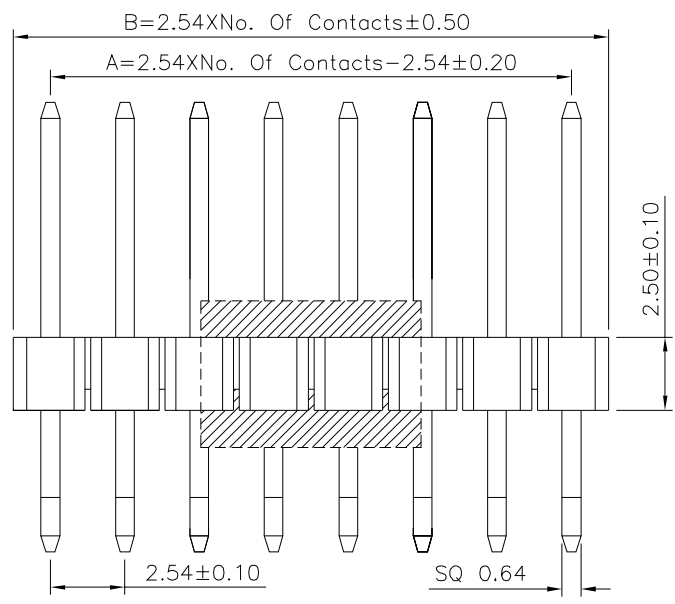
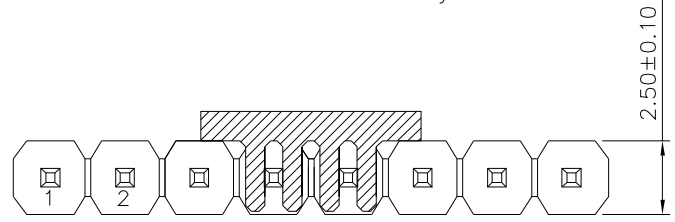

SPECIFICATION
 Current Rating: 3.0 Amp
 Contact Resistance: 20 Milliohms Max.
 Insulation Resistance: 1000 Megaohms Min.
 ⚠ Withstand Voltage: 1000V AC/Minute
 Operation Temperature: -40°C ~ +105°C
 Contact: Brass, Gold Flash Over Nickel
 Insulator: PA6T+30%G.F.(UL94V-0), Black
 RoHS Compliant

Pin	A	B	Pin	A	B
01	--	2.54	21	50.80	53.34
02	2.54	5.08	22	53.34	55.88
03	5.08	7.62	23	55.88	58.42
04	7.62	10.16	24	58.42	60.96
05	10.16	12.70	25	60.96	63.50
06	12.70	15.24	26	63.50	66.04
07	15.24	17.78	27	66.04	68.58
08	17.78	20.32	28	68.58	71.12
09	20.32	22.86	29	71.12	73.66
10	22.86	25.40	30	73.66	76.20
11	25.40	27.94	31	76.20	78.74
12	27.94	30.48	32	78.74	81.28
13	30.48	33.02	33	81.28	83.82
14	33.02	35.56	34	83.82	86.36
15	35.56	38.10	35	86.36	88.90
16	38.10	40.64	36	88.90	91.44
17	40.64	43.18	37	91.44	93.98
18	43.18	45.72	38	93.98	96.52
19	45.72	48.26	38	96.52	99.06
20	48.26	50.80	40	99.06	101.60

4UCON 元化興業股份有限公司
 4UCON TECHNOLOGY INC.

DRAWING No.		APPROVED BY		UNLESS OTHERWISE SPECIFIED TOLERANCES ARE .X ±0.30 .XX ±0.20 ANG.
20917		MEI		
		CHECKED BY		
NONE		HZF		
SCALE		DRAWING BY		UNIT mm
REV.		CYP		
A1		A1		
REV.		REVISIONS		

NO.	REV.	REVISIONS	CHK	DATE
⚠ A1		Modify Data	HZF	03/01/2018
⚠ A0		NEW RELEASE	HZF	04/22/2016