

Recommended P.C.B. Layout (Top View)  
(PCB Board Tolerance ±0.05)

- SPECIFICATION**
- Current Rating: 3A
  - Withstanding Voltage: 1000V AC Min./Minute
  - Contact Resistance: 20 Milliohms Max.
  - Insulation Resistance: 1000 Megohms Min.
  - Operation Temperature: -40°C ~ +105°C
  - Housing: PA9T (UL94V-0), Black
  - Contact: Brass, Gold Flash Over All, Over Nickel
  - RoHS Compliant

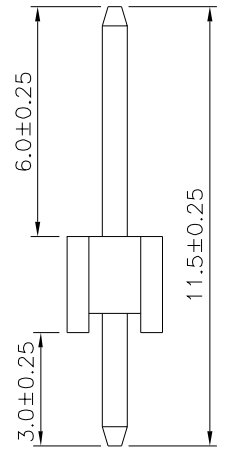
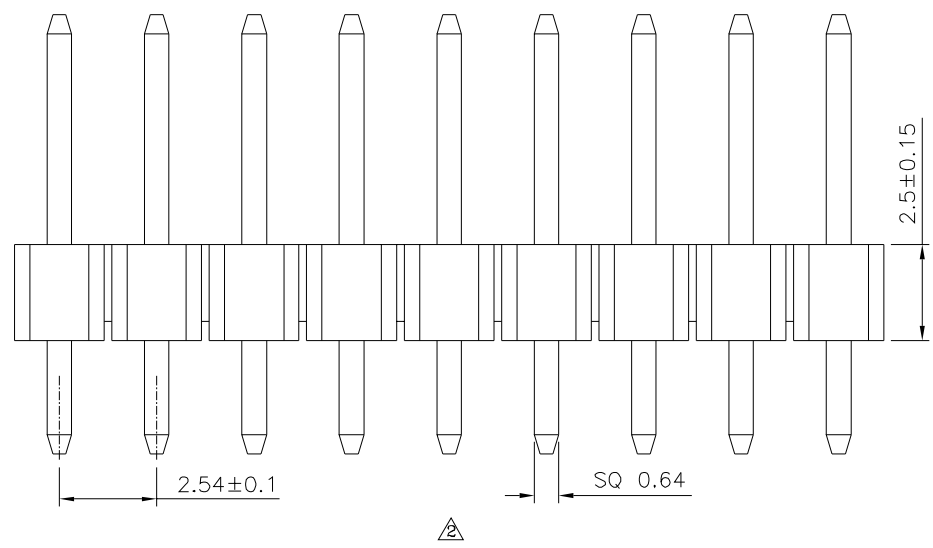
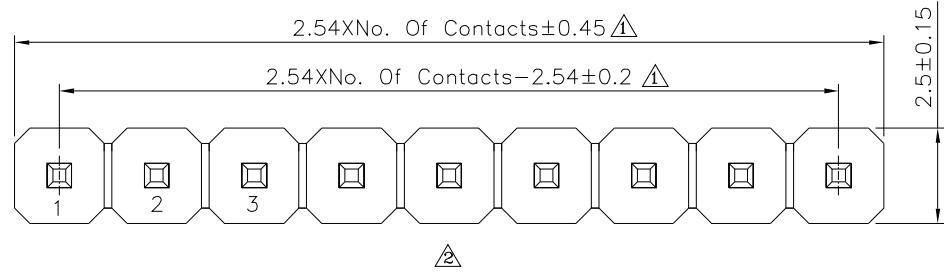

**4UCON** 元化興業股份有限公司  
4UCON TECHNOLOGY INC.

DRAWING No.		APPROVED BY		UNLESS OTHERWISE SPECIFIED TOLERANCES ARE X. ±0.25 X.* ±2* .X ±0.20 .X.* ±1.5* .XX ±0.15 .XX.* ±1* .XXX ±0.10 .XXX.* ±0.5*
22212		MEI		
		CHECKED BY		
		HZF		
		DRAWING BY		
		YBL		
SCALE	NONE	REV.	A3	UNIT
				mm

NO.	REV.	REVISIONS	CHK	DATE
3	A3	Modify Data	HZF	03/08/2024
2	A2	Modify Data	HZF	06/29/2023
1	A1	Modify Data	HZF	01/04/2017
0	A0	NEW RELEASE	HZF	05/18/2013