

Recommended PCB Layout (Top View)

SPECIFICATION

Voltage Rating:250V AC RMS
 Current rating:1 Amp
 Dielectric Withstand Voltage:500V AC RMS 60Hz For 1 Minute
 Insulation Resistance:1000 Megaohms Min. At 500V DC
 Contact Resistance:30 Milliohms Max.
 Temperature Range:-55°C~+85°C
 Retention Force:460 Grams Min. Per Contact
 Insertion Force:230 Grams Max. Per Contact Pair
 Withdrawal Force:15 Grams Min. Per Contact Pair
 Insulator:PBT(UL94V-0),White
 Contact:Brass,Gold Flash On Contact Area,Tin
 Plated On Solder Tails,Over Nickel
 RoHS Compliant

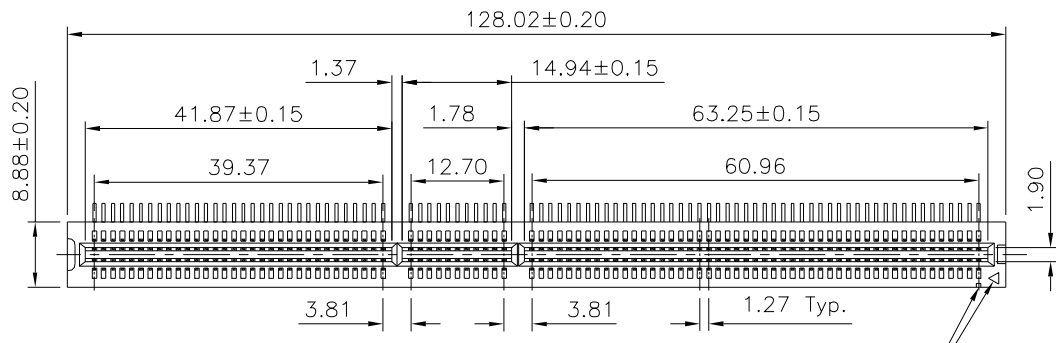

Pos. #1 Indicator

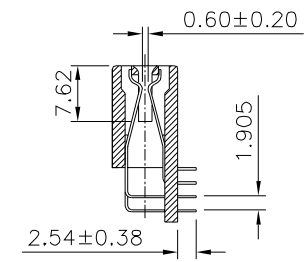
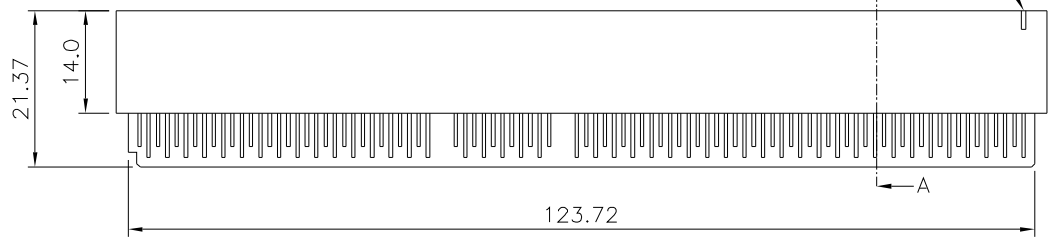

4UCON 元化興業股份有限公司
 4UCON TECHNOLOGY INC.

DRAWING No.		APPROVED BY		UNLESS OTHERWISE SPECIFIED TOLERANCES ARE X. ±0.20 .X ±0.15 .XX ±0.10 .XXX ±0.05
22341		MEI		
		CHECKED BY	HZF	
		DRAWING BY	LZX	
SCALE	NONE	REV.	A0	UNIT mm

NO.	REV.	REVISIONS	CHK	DATE
△ A0		NEW RELEASE	HZF	12/16/2021