

Recommended P.C.B. Layout

SPECIFICATION

Current Rating: 10Amps/Way Max.
 Voltage Rating: 300V AC
 Withstand Voltage: 2500V AC/Minute, Test Time=60 Sec./Pcs
 Operation Temperature: -40°C~+105°C
 Soldering Reliability Temperature: 250°C±10°C, 5 Sec. Max.
 Solder Pin: Copper Alloy, Tin Plated
 Insulator Body(Housing): Polyamide+G.F.(UL94V-0), Black
 RoHS Compliant

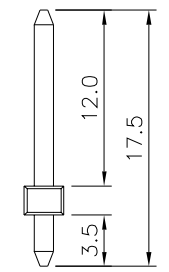
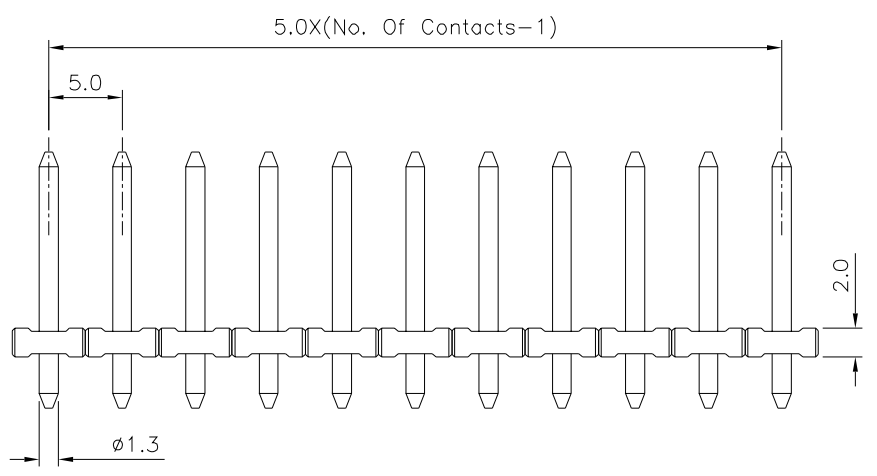
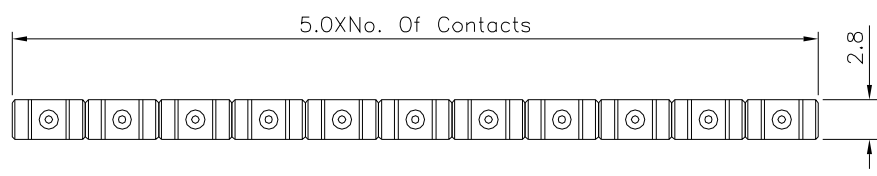

4UCON 元化興業股份有限公司
 4UCON TECHNOLOGY INC.

DRAWING No.		APPROVED BY		UNLESS OTHERWISE SPECIFIED TOLERANCES ARE X. ±0.50 .X ±0.30 .XX ±0.20 ANG. ±1°
22399		MEI		
		CHECKED BY	HZF	
SCALE	NONE	DRAWING BY	LZX	
		REV.	A0	UNIT
				mm

NO.	REV.	REVISIONS	CHK	DATE
△ A0		NEW RELEASE	HZF	03/09/2022