

**SPECIFICATION**

Current Rating:1A  
 Withstand Voltage:500V AC/Minute  
 Contact Resistance:20 Milliohms Max.  
 Insulation Resistance:1000 Megaohms Min.  
 Operation Temperature:-40°C~+105°C  
 Insulator:PA6T+30%G.F.(UL94V-0),Black  
 Contact:Brass,Gold Flash Over Nickel  
 RoHS Compliant

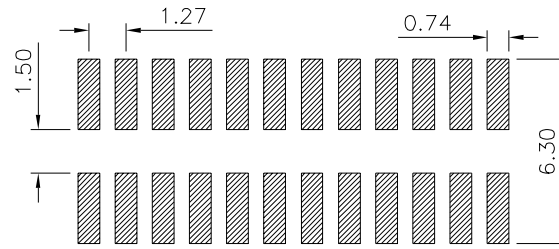

Recommended P.C.B. Layout  
 (PCB Board Tolerance±0.05)

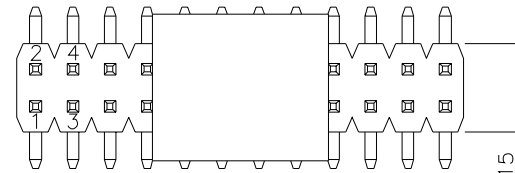

$B = 1.27 \times \text{No. of Contacts} / 2 \pm 0.30$

$A = 1.27 \times (\text{No. of Contacts} / 2 - 1) \pm 0.20$

$1.27 \pm 0.10$        $0.40 \text{ SQ}$

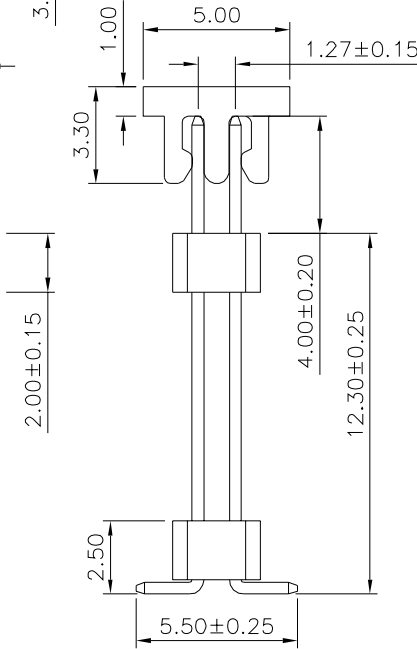

Pin	A	B	Pin	A	B
04	1.27	2.54	54	33.02	34.29
06	2.54	3.81	56	34.29	35.56
08	3.81	5.08	58	35.56	36.83
10	5.08	6.35	60	36.83	38.10
12	6.35	7.62	62	38.10	39.37
14	7.62	8.89	64	39.37	40.64
16	8.89	10.16	66	40.64	41.91
18	10.16	11.43	68	41.91	43.18
20	11.43	12.70	70	43.18	44.45
22	12.70	13.97	72	44.45	45.72
24	13.97	15.24	74	45.72	46.99
26	15.24	16.51	76	46.99	48.26
28	16.51	17.78	78	48.26	49.53
30	17.78	19.05	80	49.53	50.80
32	19.05	20.32	82	50.80	52.07
34	20.32	21.59	84	52.07	53.34
36	21.59	22.86	86	53.34	54.61
38	22.86	24.13	88	54.61	55.88
40	24.13	25.40	90	55.88	57.15
42	25.40	26.67	92	57.15	58.42
44	26.67	27.94	94	58.42	59.69
46	27.94	29.21	96	59.69	60.96
48	29.21	30.48	98	60.96	62.23
50	30.48	31.75	100	62.23	63.50
52	31.75	33.02			

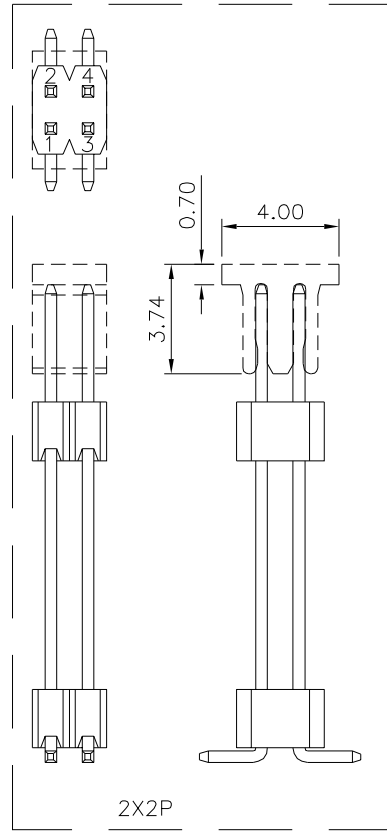

DRAWING No.

APPROVED BY

MEI

CHECKED BY

HZF

DRAWING BY

LZX

23084

UNLESS OTHERWISE SPECIFIED TOLERANCES ARE

.X ±0.30

.XX ±0.20

SCALE

NONE

REV.

A0

UNIT mm

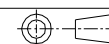

△ A0

NEW RELEASE

HZF

10/25/2023

NO. REV.

REVISIONS

CHK

DATE

**4UCON**

元化興業股份有限公司  
 4UCON TECHNOLOGY INC.