

Recommended P.C.B. Layout
PCB Tolerance: ± 0.05 (Top View)

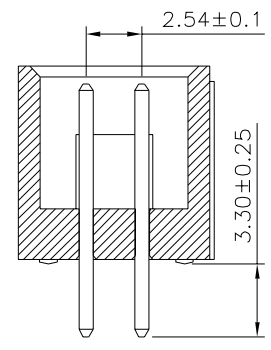
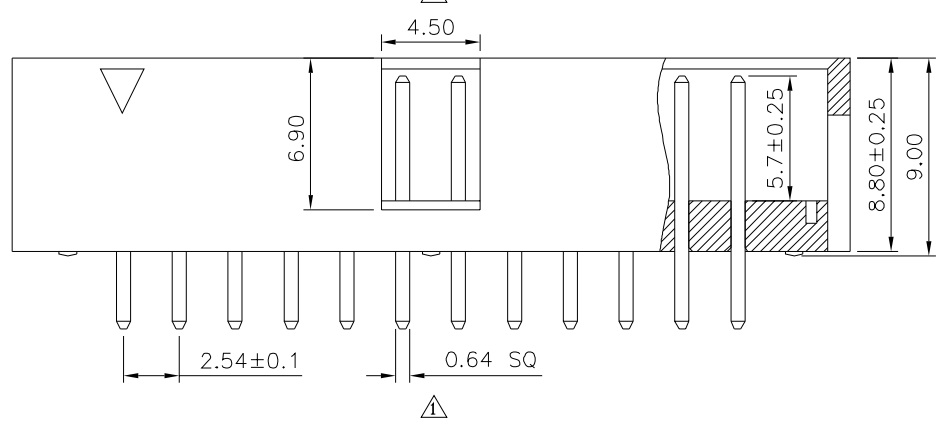
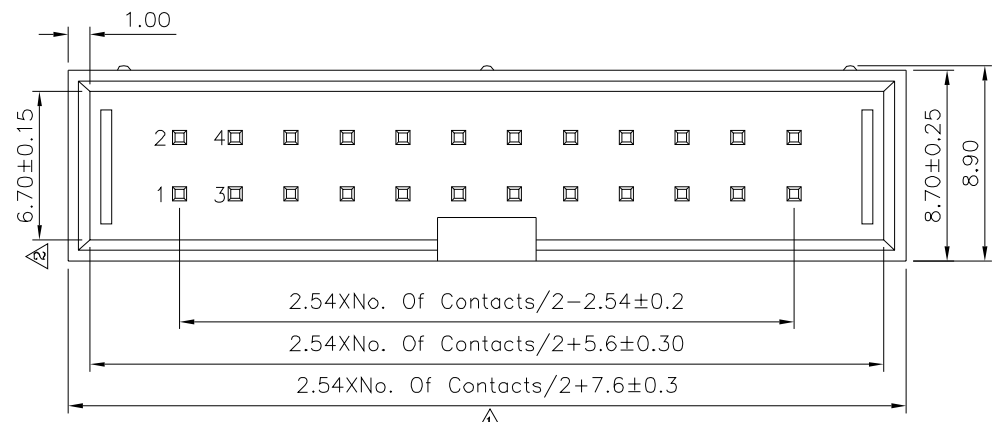

SPECIFICATION
 Current Rating: 3 Amp
 Withstand Voltage: 1000V AC
 Contact Resistance: 20 Milliohms Max.
 Insulation Resistance: 1000 Megaohms Min.
 Operation Temperature: $-40^{\circ}\text{C} \sim +105^{\circ}\text{C}$
 ⚠ Insulator: PA6T(UL94V-0), Black
 Contact: Brass, Gold Flash Over Nickel
 RoHS Compliant

4UCON 元化興業股份有限公司
 4UCON TECHNOLOGY INC.

DRAWING No. ⚠		APPROVED BY		UNLESS OTHERWISE SPECIFIED TOLERANCES ARE ⚠ X. ± 0.25 X.* $\pm 0.5^*$.X ± 0.20 .X* $\pm 0.1^*$.XX ± 0.15 .XX* $\pm 0.05^*$.XXX ± 0.10					
20902		MEI			⚠ A2	Modify Data	HZF	03/14/2019	
		CHECKED BY			⚠ A1	Modify Data	HZF	04/17/2015	
		DRAWING BY		⚠ A0	NEW RELEASE	HZF	12/29/2012		
SCALE	NONE	REV.	A2	UNIT	mm	NO. REV.	REVISIONS	CHK	DATE

